

1

Undermount Slide

More Home Furniture Possibilities

Concealed slides, the secret behind any elegant home design. Let your designs soar without worrying about the unsightliness of exposed furniture bearings weighing down your style.

With our excellent designed concealed slide, your furniture will look just the way you want it to be.



Pronounced style, classic design

Where simplicity and luxurious lifestyles meet

Our 1A88 allows you to utilize your furniture elegantly without any effort. The push-open design will completely change your views about drawers. Without the handle bar your furniture can keep its fine appearance and more stylish look can be achieved. The 1A88 employs our meticulously developed hydraulic dampers to provide long lifespan and better performance. The hydraulic dampers also bring about a smoother and quieter drawer operation. After all, you would no longer be afflicted by squeaky/hard to operate drawers. The 1A88 is the hidden foundation in life that you deserve.

The World's First Electric-Free All-Mechanical Design

King Slide flawlessly combined the touch-to-open and soft-closing technologies in 1A88. Unlike other brands, King Slide uses all-mechanical patent pending design that will not only save electricity but also promote green technology. With King Slide's all-mechanical design, 1A88 concocts your personal style and green life!



1A88

**Push-Open with Silent Soft-Closing
Undermount Slide**

Awarded Prizes



Best of KBIS: Best of Kitchen Gold Award

The Kitchen & Bath Industry Show (KBIS) is the world’s largest international trade event that focuses specially on all aspects of kitchens and baths. The winners of the 2010 Best of KBIS Competition announced at the show highlight exceptional products introduced in the past 12 months for their functionality, quality, flexibility, aesthetics, style and innovation.



IWF 2010 Challengers Award® Winner

The IWF Challengers Award® is widely known as the woodworking industry’s highest honor, recognizing advancements in technologies or significant contributions to environmental improvements. The award challenges IWF exhibiting companies to develop revolutionary, ingenious and forward-thinking technologies, materials and safety devices that advance the industry.



TAIWAN Excellence 2011

Taiwan Excellence is the highest accolade awarded to products that encapsulate innovation. Taiwan Excellence winners represent the most revolutionary, high quality, high value added products/designs made by Taiwan.

Operation Manual

Way 1.

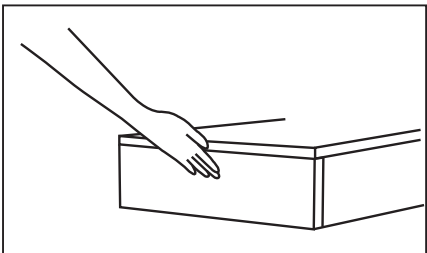

A) Press the Drawer Front

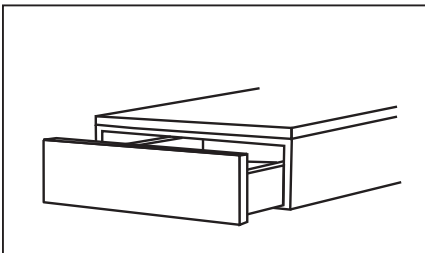

B) Drawer Opens Automatically via Mechanism

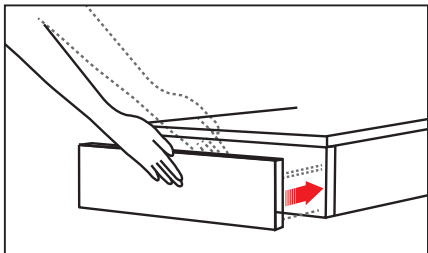

C) Press to Close the Drawer

Way 2.

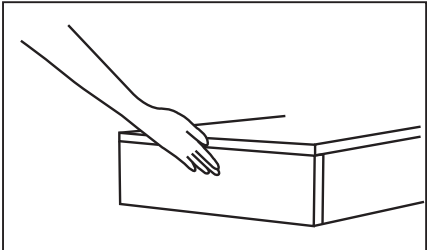

A) Press the Drawer Front

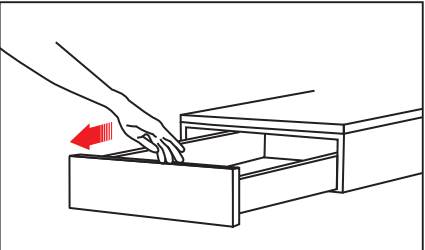

B) Pull the Drawer for Your Use

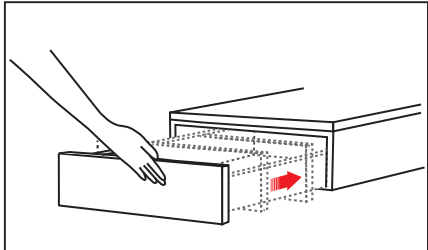

C) Silent Soft-Closing

1A88

Push-Open with Silent Soft-Closing
Undermount Slide (16mm)



Specifications

- **Length:** 250mm to 550mm
- **Travel:** Full Extension
- **Maximum Drawer Side Thickness:** 16mm
- **Max. Load Capacity:** 34 kg (75 lb) /pair
- **Mount:** Undermount
- **Material:** Galvanized Steel
- **Packing:** Unit Packed in 2 pairs/carton
6 pairs/carton

Features

- Push-open, handle-free.
- Enhanced silent soft-closing feature with light opening force
- Durable damping system with fast response capability
- All mechanical device, instead of electric-driven
- Safe, user-friendly and energy saving
- Undermount with full extension travel length
- Ultra smooth gliding motion with high rigidity and stability design
- Ergonomic trimming system provides tool-less height and depth adjustments
- A tool-less adjustment system is available to compensate for minor tolerances thereby reducing installation complexity
- Effortless assembly and removal of drawer with front release latch



Applications

- For Frameless Cabinet : Kitchen Furniture, Kitchen Cabinetry, Home Cabinetry and Box Drawers

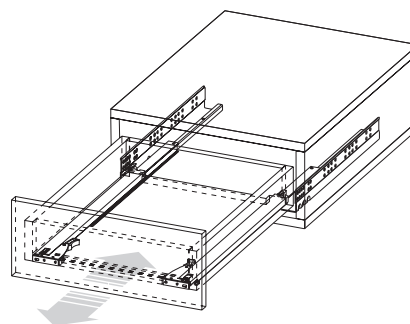

Dimension Specifications

Cabinet Holes Position

● Red Dots : Minimum Screw Required
Note: Ensure the slide is parallel to the horizon or tilt to cabinet front on both sides during installation.

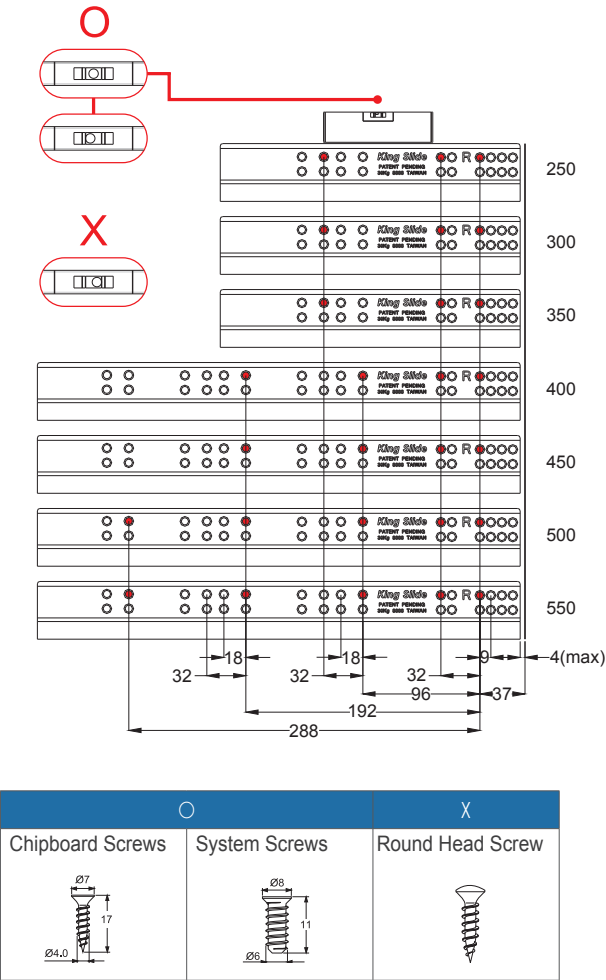

Space Requirement

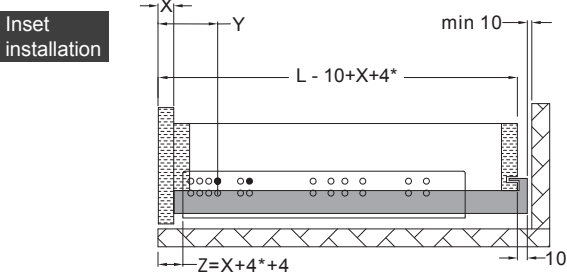
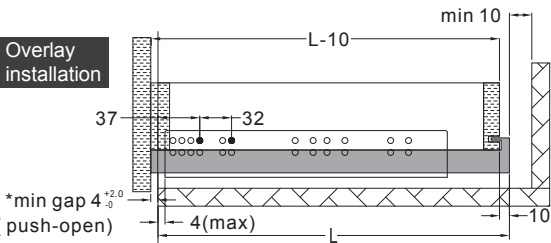
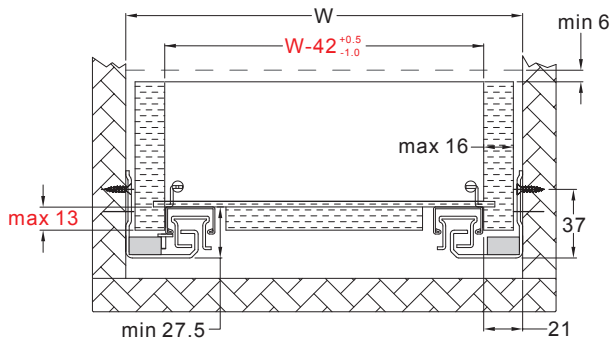

Inset Install Formula							
x	18	19	20	21	22	23	24
Y	59	60	61	62	63	64	65
Z	26	27	28	29	30	31	32

L: Slide Length X: Front Panel Thickness

Note: Holes other than those shown may be in the slide member at King Slide's option and may change without notice.

Item No.	Total Length (mm)	Slide Travel (mm)	Self-Closing Travel (mm)	Loading Capacity kg(lb) / pair
1A88-250	250	224	30	34 (75)
1A88-300	300	280	30	34 (75)
1A88-350	350	340	30	34 (75)
1A88-400	400	390	45	34 (75)
1A88-450	450	440	45	34 (75)
1A88-500	500	490	45	34 (75)
1A88-550	550	540	45	34 (75)

Easy Assembly with Front-End Installation

Tool-Less Height Adjustment :
Simply rotate the wheel at the front bottom of the drawer to adjust the drawer height

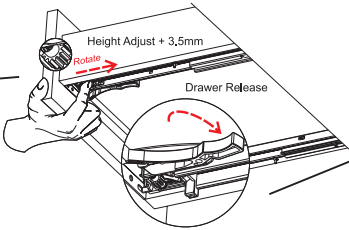

Drawer Removal:
Simply press the front release device to remove the drawer

1B88

Push-Open with Silent Soft-Closing
Undermount Slide (19mm)



Specifications

- **Length:** 250mm to 550mm
- **Travel:** Full Extension
- **Maximum Drawer Side Thickness:** 19mm
- **Max. Load Capacity:** 34 kg (75 lb)/pair
- **Mount:** Undermount
- **Material:** Galvanized Steel
- **Packing:** Unit Packed In 2 pairs/carton
6 pairs/carton

Features

- Push-open, handle-free
- Enhanced silent soft-closing feature with light opening force
- Durable damping system with fast response capability
- All mechanical device, instead of electric-driven
- Safe, user-friendly and energy saving
- Undermount with full extension travel length
- Ultra smooth gliding motion with high rigidity and stability design
- Ergonomic trimming system provides tool-less height and depth adjustments
- A tool-less adjustment system is available to permit minor installation inaccuracies, thereby reducing assemblage complexity.
- Effortless assembly and removal of drawer with front release lever
- High installation allowances for drawer width: +0.5/-1mm, and for drawer depth: +1/-1mm



Applications

- For Frameless Cabinet : Kitchen Furniture, Kitchen Cabinetry, Home Cabinetry and Box Drawers

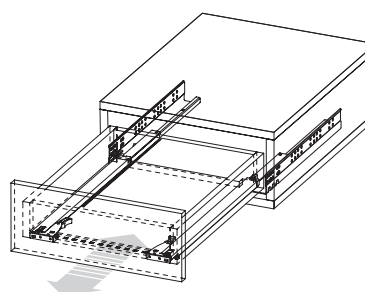

Dimension Specifications

Cabinet Holes Position

- Red Dots : Minimum Screw Required
- Note: Ensure the slide is parallel to the horizon or tilt to cabinet front on both sides during installation.

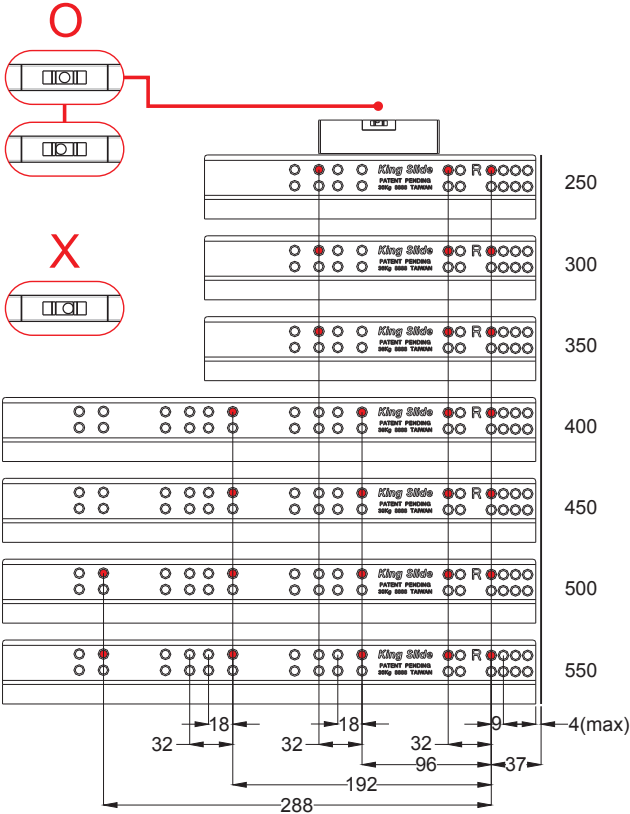

Note: Holes other than those shown may be in the slide member at King Slide's option and may change without notice.

Space Requirement

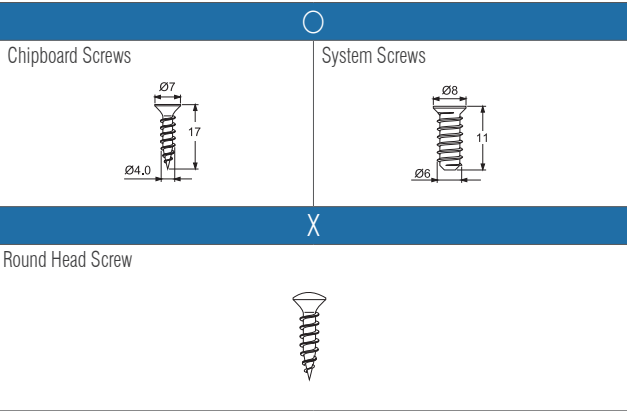
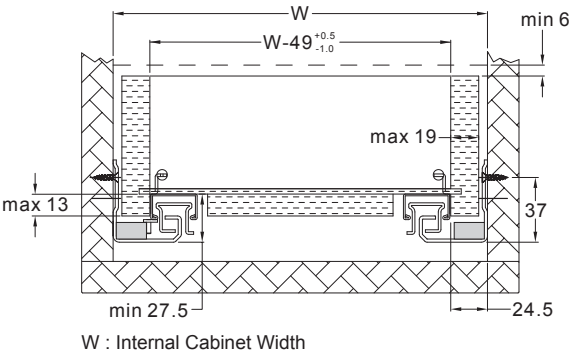

Item No.	Total Length (mm)	Slide Travel (mm)	Self-Closing Travel (mm)	Loading Capacity kg(lb) / pair
1B88-250	250	224	30	34 (75)
1B88-300	300	280	30	34 (75)
1B88-350	350	340	30	34 (75)
1B88-400	400	390	45	34 (75)
1B88-450	450	440	45	34 (75)
1B88-500	500	490	45	34 (75)
1B88-550	550	540	45	34 (75)

Easy Assembly with Front-End Installation

Tool-Less Height Adjustment :
Simply rotate the wheel at the front bottom of the drawer to adjust the drawer height

Drawer Removal:
Simply press the front release device to remove the drawer

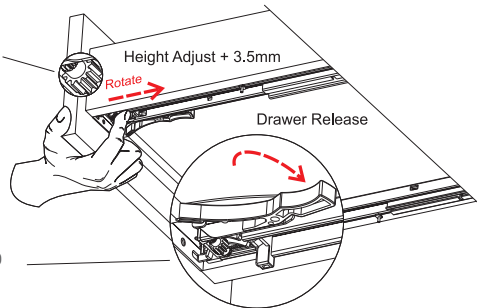

Our specially designed front-end installation allows quick and simple drawer installation and removal processes. The quick connect and disconnect device is located at the front-end under the drawer, keeping intact the elegant appearance of the drawer.

Installation Instruction

1A88 & 1B88

1. Before installing the slides, make sure the dimensions of the cabinet and drawer meet the requirements specified in Fig. 1 and Fig. 2.
2. Drill holes on the cabinet following the 'Cabinet Holes Position' drawing on the reverse page. Mount the slides on the cabinet using the recommended type of screws.
3. Make cut-outs on the drawer according to Fig. 3A and Fig. 3B's dimension (Using the drill template FL00ZD0-A as page 1.39 is recommended), then install the front release lever according to Fig. 3A.
4. Pull out the slides on the cabinet.

Fig. 1 Dimension Specification

Front View

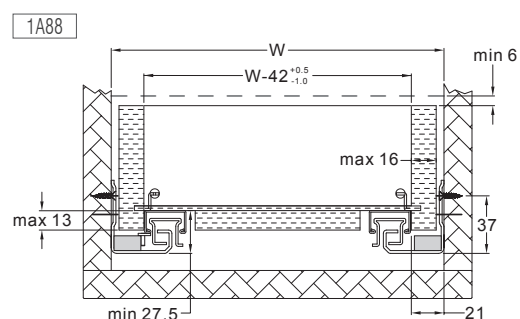

W : Internal Cabinet Width

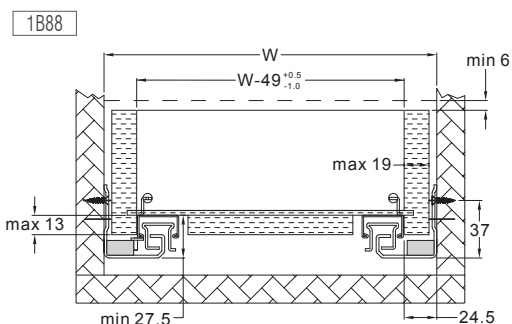

W : Internal Cabinet Width

Fig. 2

Side View

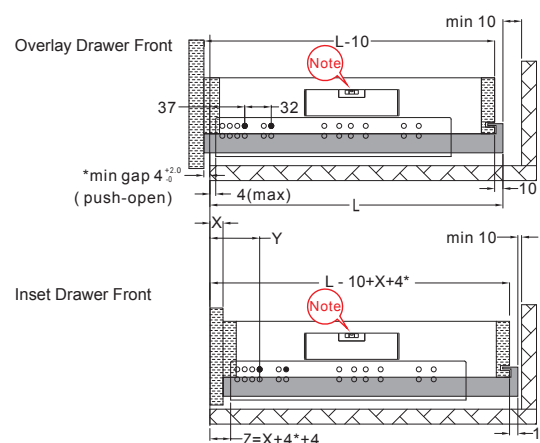

Note:

Ensure the slide is parallel to the horizon or tilt to cabinet front on both sides during installation.

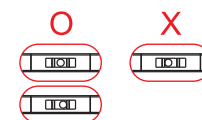

Inset Install Formula

Inset Install Formula							
x	18	19	20	21	22	23	24
Y	59	60	61	62	63	64	65
Z	26	27	28	29	30	31	32

L: Slide Length X: Front Panel Thickness

Installation Specification

Fig. 3A

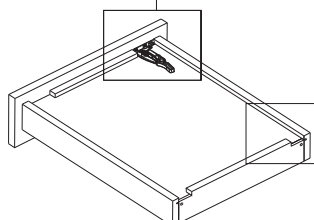
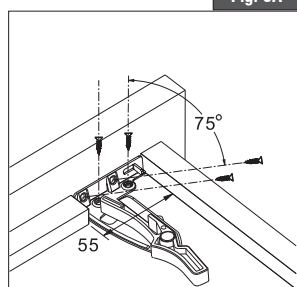
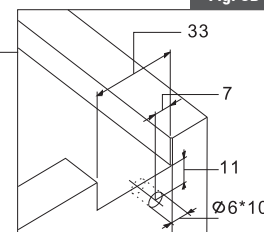
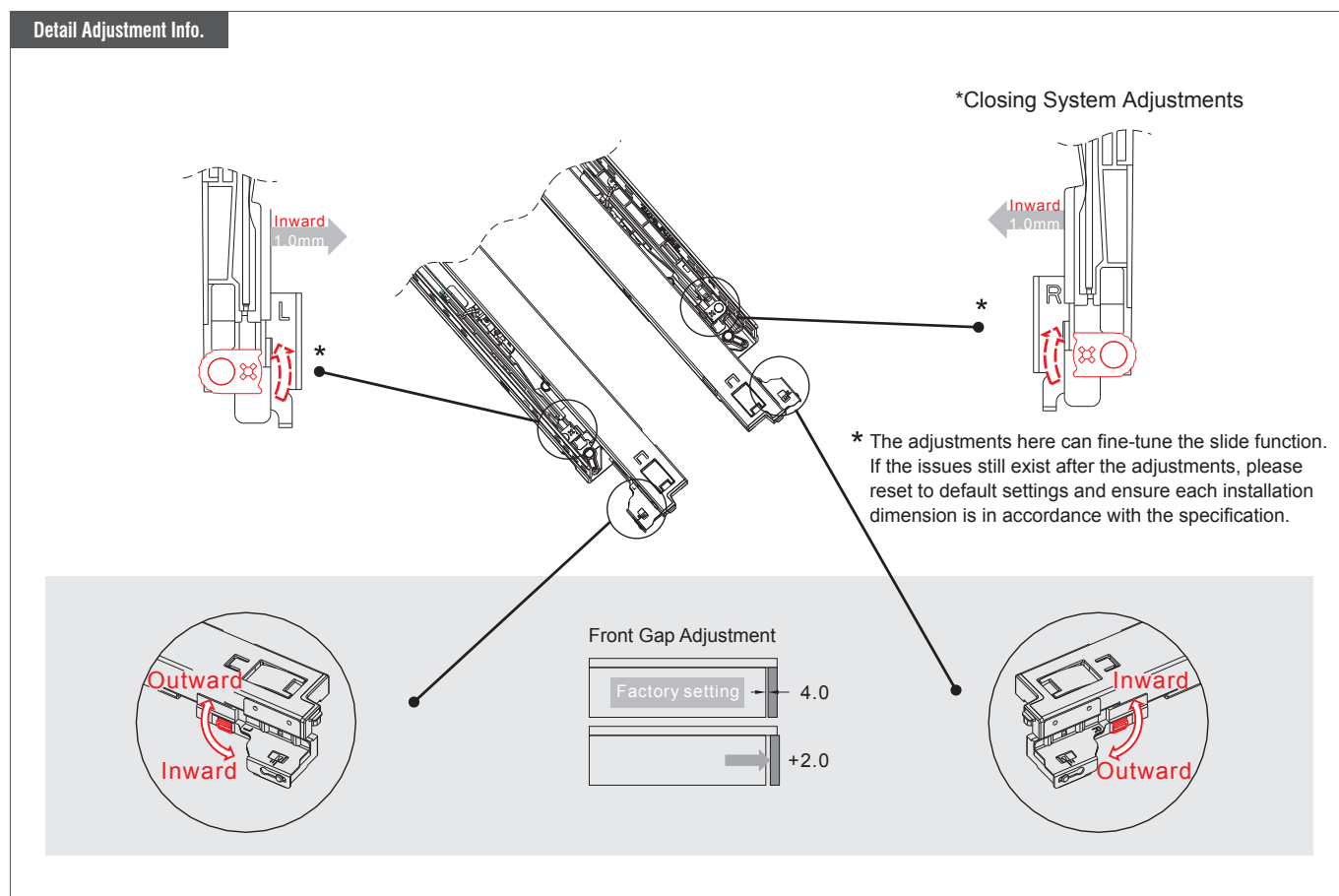
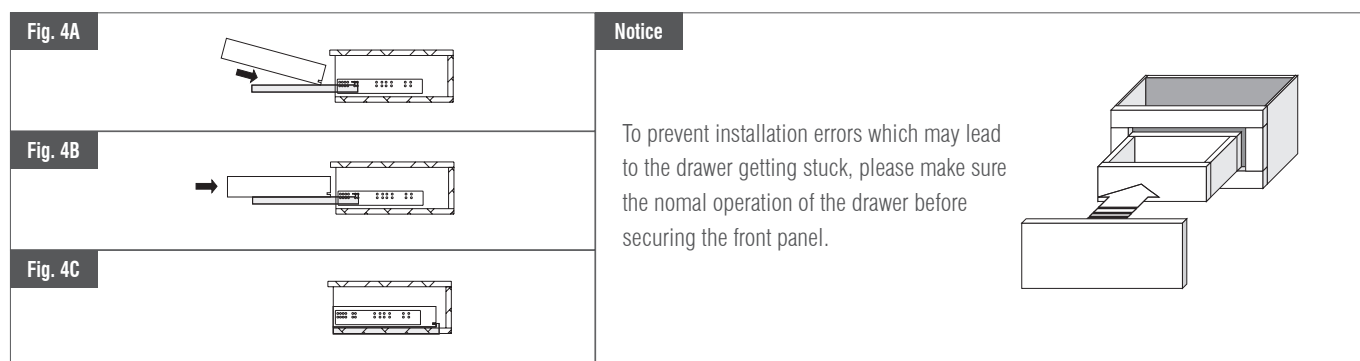

Fig. 3B



You can use optional drill template FL-00ZD0-A as page 1.39

5. Position and align the drawer with the slide as shown in Figs. 4A and 4B. Push the drawer all the way into the cabinet as shown in Fig. 4C until clicked to complete the installation.
6. After confirming the drawer is operating normally, install the front panel.
7. If height / depth adjustment is needed after installation, please refer to the Detail Adjustment Info. below or the feature diagram on the previous page.



Notes for installation

1. Ensure the drawer body appearance is upright. It could not be diamond trapezoidal or distorted!
2. Ensure the side space, depth on both sides are consistent.
3. Ensure the installation location or the cabinet is on a flat surface.
4. Ensure the front release lever is installed correctly.
5. Ensure the drawer dimensions, rear notch locking hole, internal drawer width, and the drawer bottom recess are correct.

1A88F

Push-Open with Silent Soft-Closing

Undermount Slide for Face Frame Cabinet
(16mm)

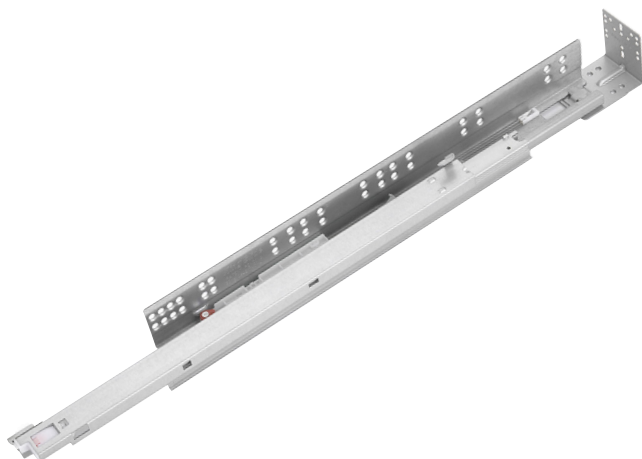

Specifications

- **Length:** 305 / 381 / 457 / 533mm
12" / 15" / 18" / 21"
- **Travel:** Full Extension
- **Maximum Drawer Side Thickness:** 16mm(5/8")
- **Max. Load Capacity:** 34 kg(75 lb)/pair
- **Mount:** Undermount
- **Material:** Galvanized Steel
- **Packing:** Unit Packed in 2 pairs/carton
6 pairs/carton

Features

- Push-open, handle-free
- Enhanced silent soft-closing feature with light opening force
- Durable damping system with fast response capability
- All mechanical device, instead of electric-driven
- Safe, ergonomic and energy saving
- Undermount with full extension travel length
- Ultra smooth gliding motion with high rigidity and stability design
- 2 dimensional trimming system provides tool-less height and depth adjustments
- A tool-less adjustment system is available to permit minor installation inaccuracies, thereby reducing assemblage complexity.
- Effortless assembly and removal of drawer with front release lever
- High installation allowances for drawer width: +0.5/-1mm, and for drawer depth: +1/-1mm

Applications

- For Face Frame Cabinet : Kitchen Furniture, Kitchen Cabinetry, Home Cabinetry and Box Drawers

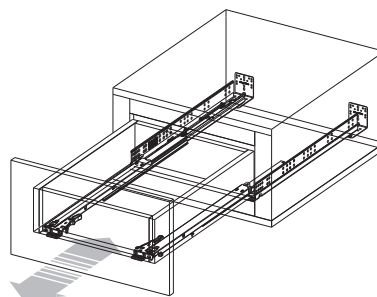

Space Requirement

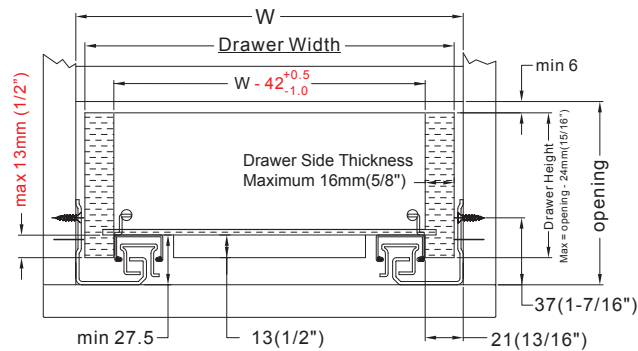

Drawer Width Formula	
Drawer Side Thickness mm (inch)	"W" minus mm (inch)
16 (5/8")	10 (3/8")
15 (19/32")	12 (15/32")
14 (9/16")	14 (9/16")
13 (1/2")	16 (5/8")
12 (15/32")	18 (23/32")

W: Internal Cabinet Width
Example:
Internal Cabinet Width = 457 mm (18")
Drawer Side Thickness = 13 mm (1/2")
Drawer width = 457 - 16 = 441^{+0.5}_{-1.0} mm
= (18") - (5/8") = 17-3/8"

Dimension Specifications

Note: Holes other than those shown may be in the slide member at King Slide's option and may change without notice.

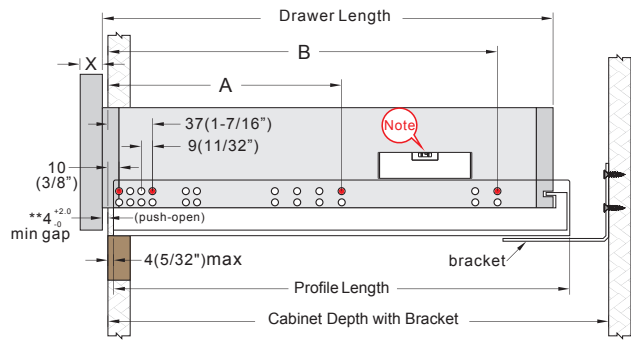

Chipboard Screws

System Screws

Round Head Screw

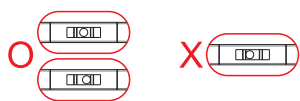

Note:
Ensure the slide is parallel to the horizon or tilt to cabinet front on both sides during installation.

Item No.	Drawer Length mm (inch)	Overall Cabinet Depth mm (inch)	Cabinet Depth With Bracket mm (inch)		Profile Length mm (inch)	System Screw Locations mm (inch)	
			MAX	MIN		A	B
1A88F305	305 (12")	381 (15")	369 (14-9/16")	326 (12-7/8")	318 (12-1/2")	165 (6-1/2")	261 (10-1/4")
1A88F381	381 (15")	457 (18")	446 (17-9/16")	403 (15-7/8")	394 (15-1/2")	165 (6-1/2")	357 (14-1/16")
1A88F457	457 (18")	533 (21")	522 (20-9/16")	479 (18-7/8")	470 (18-1/2")	261 (10-1/4")	453 (17-13/16")
1A88F533	533 (21")	610 (24")	598 (23-9/16")	555 (21-7/8")	546 (21-1/2")	261 (10-1/4")	517 (20-3/8")

Fit with American standard 3" cabinet depth system.

Easy Assembly with Front-End Installation

Tool-less Height Adjustment :
Simply rotate the wheel at the front bottom of the drawer to adjust the drawer height

Drawer Removal:
Simply press the front release device to remove the drawer

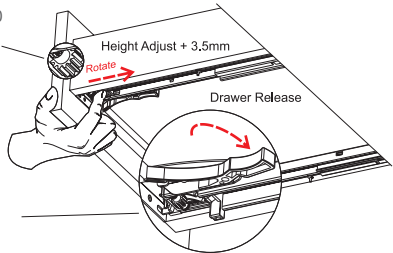

Our specially designed front-end installation allows quick and simple drawer installation and removal processes. The quick connect and disconnect device is located at the front-end under the drawer, keeping intact the elegant appearance of the drawer.

1B88F

Push-Open with Silent Soft-Closing Undermount Slide for Face Frame Cabinet (19mm)

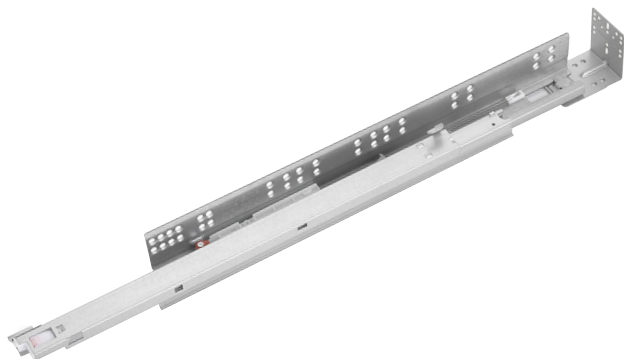

Specifications

- **Length:** 305 / 381 / 457 / 533mm
12" / 15" / 18" / 21"
- **Travel:** Full Extension
- **Maximum Drawer Side Thickness:** 19mm
- **Max. Load Capacity:** 34 kg (75 lb)/pair
- **Mount:** Undermount
- **Material:** Galvanized Steel
- **Packing:** Unit Packed in 2 pairs/carton
6 pairs/carton

Features

- Push-open, handle-free
- Enhanced silent soft-closing feature with light opening force
- Durable damping system with fast response capability
- All mechanical device, instead of electric-driven
- Safe, ergonomic and energy saving
- Undermount with full extension travel length
- Ultra smooth gliding motion with high rigidity and stability design
- 2 dimensional trimming system provides tool-less height and depth adjustments
- A tool-less adjustment system is available to permit minor installation inaccuracies, thereby reducing assemblage complexity.
- Effortless assembly and removal of drawer with front release lever
- High installation allowances for drawer width: +0.5/-1mm, and for drawer depth: +1/-1mm

Applications

- For Face Frame Cabinet : Kitchen Furniture, Kitchen Cabinetry, Home Cabinetry and Box Drawers

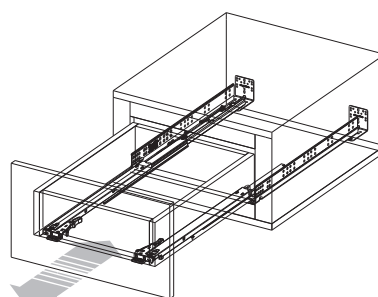

Space Requirement

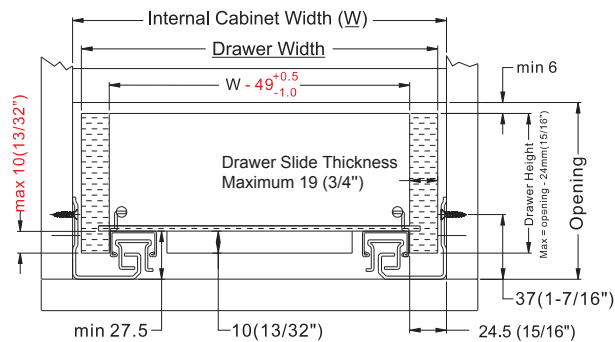

Drawer Width Formula	
Drawer Side Thickness mm (inch)	"W" minus mm (inch)
19 (3/4")	11 (7/16")
18 (23/32")	13 (1/2")
17 (21/31")	15 (19/32")
16 (5/8")	17 (21/32")
15 (19/32")	19 (3/4")

W: Internal Cabinet Width
Example:
Internal Cabinet Width = 457 mm (18")
Drawer Side Thickness = 19 mm (3/4")
Drawer width = 457 - 11 = 446 +0.5 -1.0 mm
= (18") - (7/16") = 17-9/16"

Dimension Specifications

Note: Holes other than those shown may be in the slide member at King Slide's option and may change without notice.

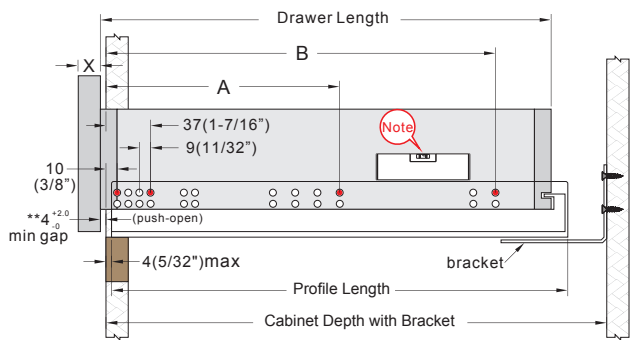

Chipboard Screw

System Screw

Round Head Screw

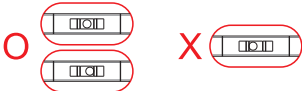

Note:
Ensure the slide is parallel to the horizon or tilt to cabinet front on both sides during installation.

Item No.	Drawer Length mm (inch)	Overall Cabinet Depth mm (inch)	Cabinet Depth With Bracket mm (inch)		Profile Length mm (inch)	System Screw Locations mm (inch)	
			MAX	MIN		A	B
1B88F305	305 (12")	381 (15")	369 (14-9/16")	326 (12-7/8")	318 (12-1/2")	165 (6-1/2")	261 (10-1/4")
1B88F381	381 (15")	457 (18")	446 (17-9/16")	403 (15-7/8")	394 (15-1/2")	165 (6-1/2")	357 (14-1/16")
1B88F457	457 (18")	533 (21")	522 (20-9/16")	479 (18-7/8")	470 (18-1/2")	261 (10-1/4")	453 (17-13/16")
1B88F533	533 (21")	610 (24")	598 (23-9/16")	555 (21-7/8")	546 (21-1/2")	261 (10-1/4")	517 (20-3/8")

Fit with American standard 3" cabinet depth system.

Easy Assembly with Front-End Installation

Tool-less Height Adjustment :
Simply rotate the wheel at the front bottom of the drawer to adjust the drawer height

Drawer Removal:
Simply press the front release device to remove the drawer

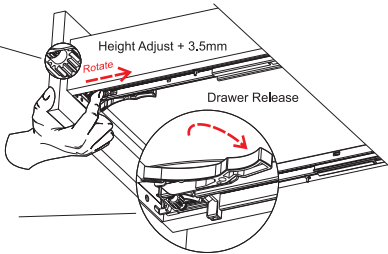

Our specially designed front-end installation allows quick and simple drawer installation and removal processes. The quick connect and disconnect device is located at the front-end under the drawer, keeping intact the elegant appearance of the drawer.



Installation Instruction

1A88F & 1B88F

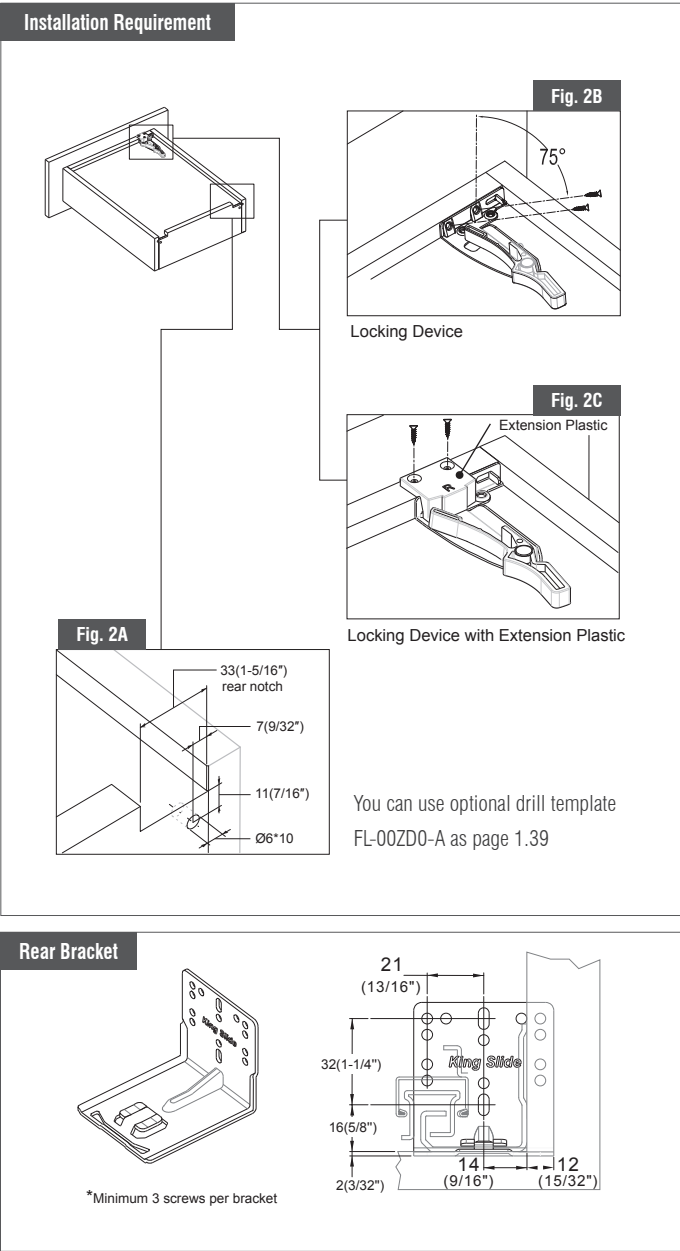
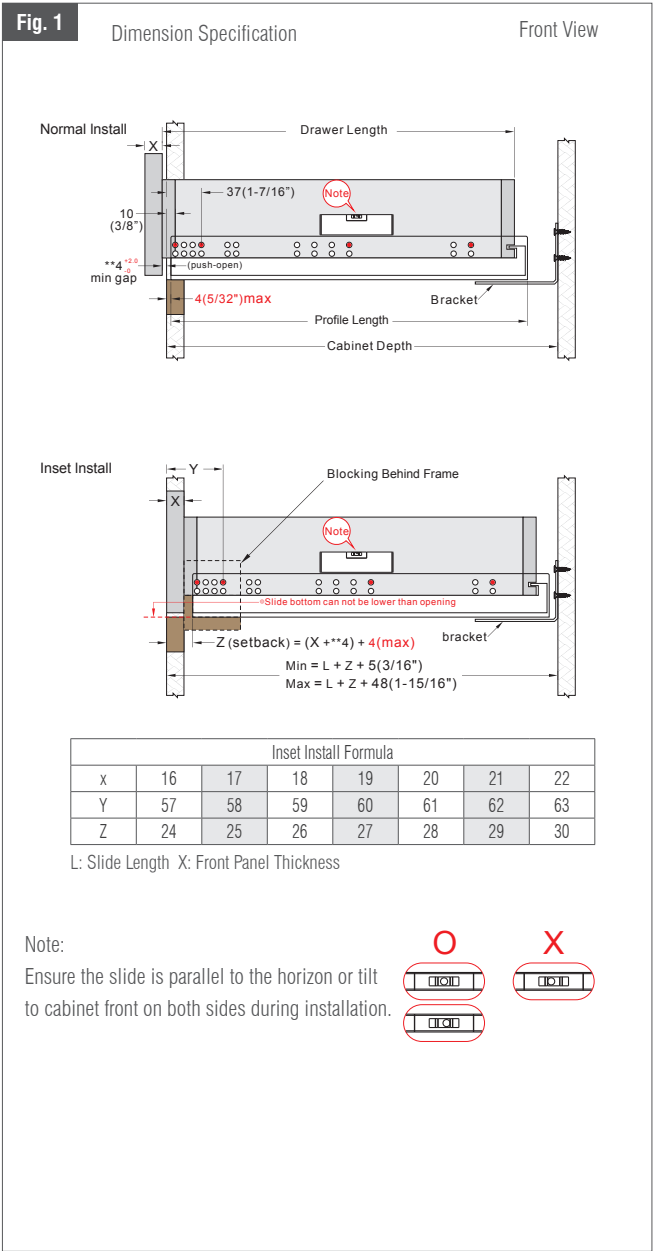
- 1. Before installing the slides, make sure the dimensions of the cabinet and drawer meet the requirements specified in Fig. 1 and 'Space Requirement' drawing resectively for the slide to be installed.
- 2. Drill holes on the cabinet following the 'Installing Specification' drawing on the reverse page. Mount the slides and the rear brackets on the cabinet using the recommended type of screws.
- 3. Make cut-outs on the drawer according to Fig. 2A 's dimension (Using the drill template FL00ZD0-A as page 1.39 is recommended) , then install the front release lever according to Fig. 2B and 2C.
- 4. Pull out the slides on the cabinet.

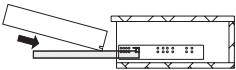
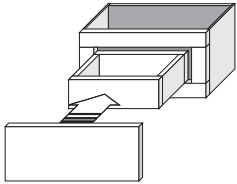
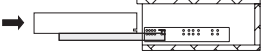

- 5. Position and align the drawer with the slide as shown in Fig. 3A and 3B. Push the drawer all the way into the cabinet as shown in Fig. 3C until clicked to complete the installation.
- 6. After confirming the drawer is operating normally, install the front panel.
- 7. If height / depth adjustment is needed after installation, please refer to the Detail Adjustment Info. below or the feature diagram on the previous page.

Fig. 3A		Notice To prevent installation errors which may lead to the drawer getting stuck, Please make sure the normal operation of the drawer before securing the front panel.	
Fig. 3B			
Fig. 3C			

Detail Adjustment Info

***Closing System Adjustments**

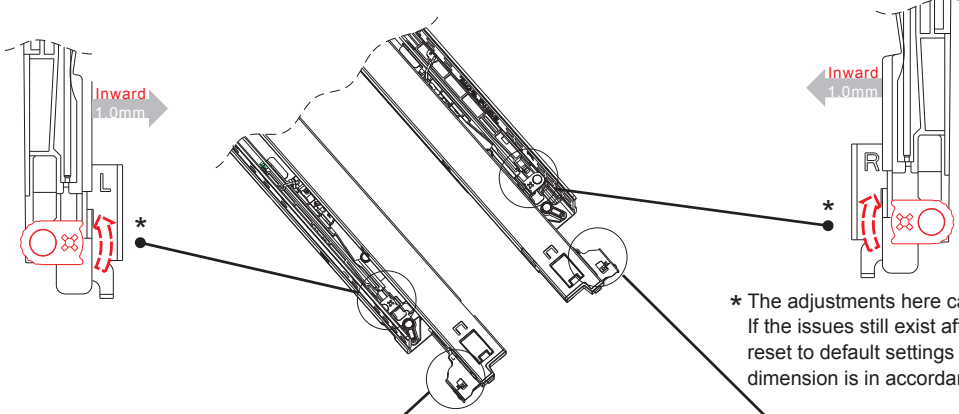

*** The adjustments here can fine-tune the slide function. If the issues still exist after the adjustments, please reset to default settings and ensure each installation dimension is in accordance with the specification.**

Front Gap Adjustment

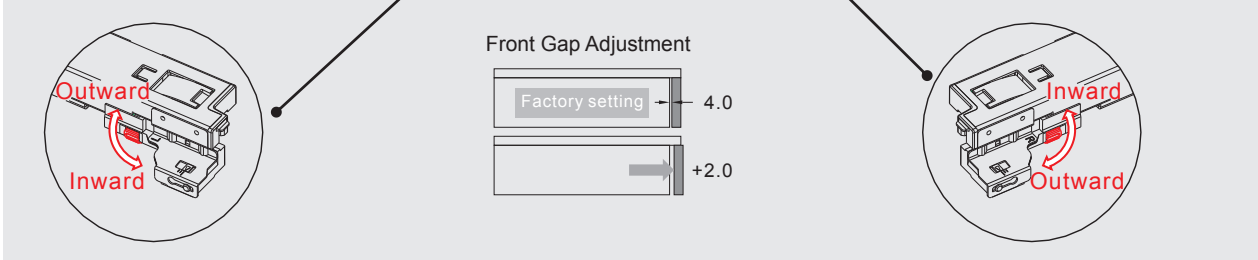

Notes for installation

- 1. Ensure the drawer body appearance is upright. It could not be diamond trapezoidal or distorted!
- 2. Ensure the side space, depth on both sides are consistent.
- 3. Ensure the installation location or the cabinet is on a flat surface.
- 4. Ensure the front release lever is installed correctly.
- 5. Ensure the drawer dimensions, rear notch locking hole, internal drawer width, and the drawer bottom recess are correct.

1A89

Push-Open Undermount Slide (16mm)



Specifications

- **Length:** 250mm to 600mm
- **Travel:** Full Extension
- **Maximum Drawer Side Thickness:** 16mm
- **Max. Load Capacity:** 45 kg(100 lb)/pair
- **Mount:** Undermount
- **Material:** Galvanized Steel
- **Packing:** Unit Packed in 2 pairs/carton
6 pairs/carton

Features

- Handle-free push-open allowing for complete drawer access even when hands are full
- Drawers can be ejected to its full extent even when at its full weight bearing capacity
- All mechanical device, instead of electric-driven, ergonomic and energy saving
- Undermount with full extension travel length
- Ultra smooth with high rigidity and stability design
- Signature patent pending tool-less ejection-force adjustment to fit your convenience
- Ergonomic design to increase usability and efficiency
- 2 dimensional trimming system provides tool-less height and depth adjustments
- Effortless assembly and removal of drawer with front release latch
- High dynamic loading capacity of 34kg (75lb) with 100,000 life cycles, or 45kg (100lb) with 50,000 life cycles

Applications

- For Frameless Cabinet :Kitchen Furniture, Kitchen Cabinetry, Home Cabinetry and Box Drawers

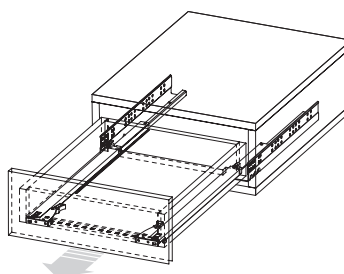

Dimension Specifications



Cabinet Holes Position

- Red Dots : Minimum Screw Required

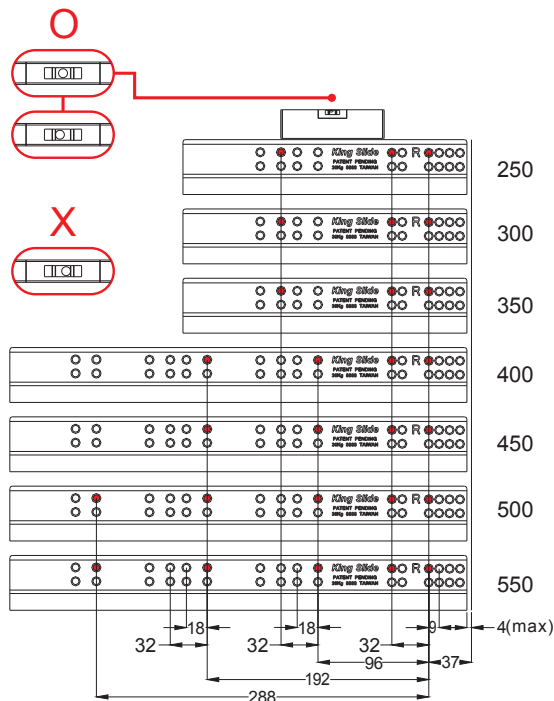
Note: Ensure the slide is parallel to the horizon or tilt to cabinet front on both sides during installation.



Note: Holes other than those shown may be in the slide member at King Slide's option and may change without notice.

○		X
Chipboard Screws	System Screws	Round Head Screw
		

Space Requirement

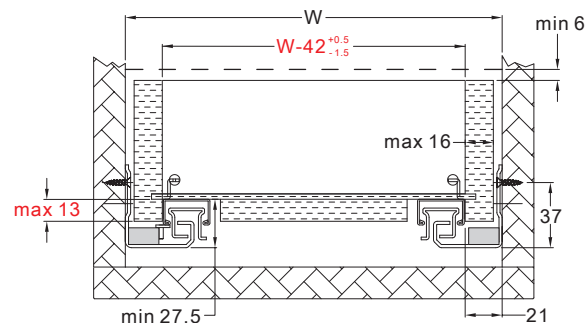

W : Internal Cabinet Width

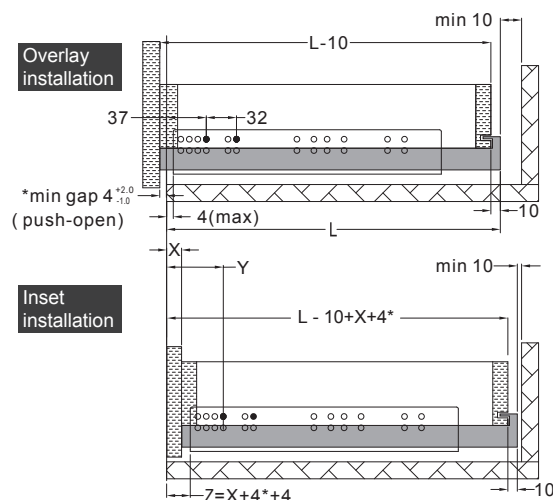

Inset Install Formula							
x	18	19	20	21	22	23	24
Y	59	60	61	62	63	64	65
Z	26	27	28	29	30	31	32

L: Slide Length X: Front Panel Thickness

Item No.	Total Length (mm)	Slide Travel (mm)	Max. Loading Capacity kg(lb) / pair
1A89-250	250	224	45 (100)
1A89-300	300	280	45 (100)
1A89-350	350	340	45 (100)
1A89-400	400	390	45 (100)
1A89-450	450	440	45 (100)
1A89-500	500	490	45 (100)
1A89-550	550	540	45 (100)
1A89-600	600	590	45 (100)

Easy Assembly with Front-End Installation

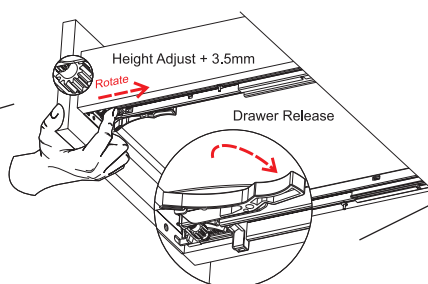

Tool-less Height Adjustment :
Simply rotate the wheel at the front bottom of
the drawer to adjust the drawer height

Drawer Removal:
Simply press the front release device to
remove the drawer

1B89

Push-Open Undermount Slide (19mm)



Specifications

- **Length:** 250mm to 550mm
- **Travel:** Full Extension
- **Maximum Drawer Side Thickness:** 19mm
- **Max. Load Capacity:** 45 kg(100 lb)/pair
- **Mount:** Undermount
- **Material:** Galvanized Steel
- **Packing:** Unit Packed in 2 pairs/carton
6 pairs/carton

Features

- Handle-free push-open allowing for complete drawer access even when hands are full
- Drawers can be ejected to its full extent even when at its full weight bearing capacity
- All mechanical device, instead of electric-driven, ergonomic and energy saving
- Undermount with full extension travel length
- Ultra smooth with high rigidity and stability design
- Signature patent pending tool-less ejection-force adjustment to fit your convenience
- Ergonomic design to increase usability and efficiency
- 2 dimensional trimming system provides tool-less height and depth adjustments
- Effortless assembly and removal of drawer with front release lever
- High dynamic loading capacity of 34kg (75lb) with 100,000 life cycles, or 45kg (100lb) with 50,000 life cycles
- High installation allowances for drawer width: +0.5/-1.5 mm, and for drawer depth: +1/-1 mm

Applications

- For Frameless Cabinet : Kitchen Furniture, Kitchen Cabinetry, Home Cabinetry and Box Drawers

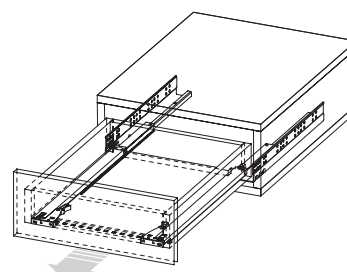

Dimension Specifications

Cabinet Holes Position

● Red Dots : Minimum Screw Required
Note: Ensure the slide is parallel to the horizon or tilt to cabinet front on both sides during installation.

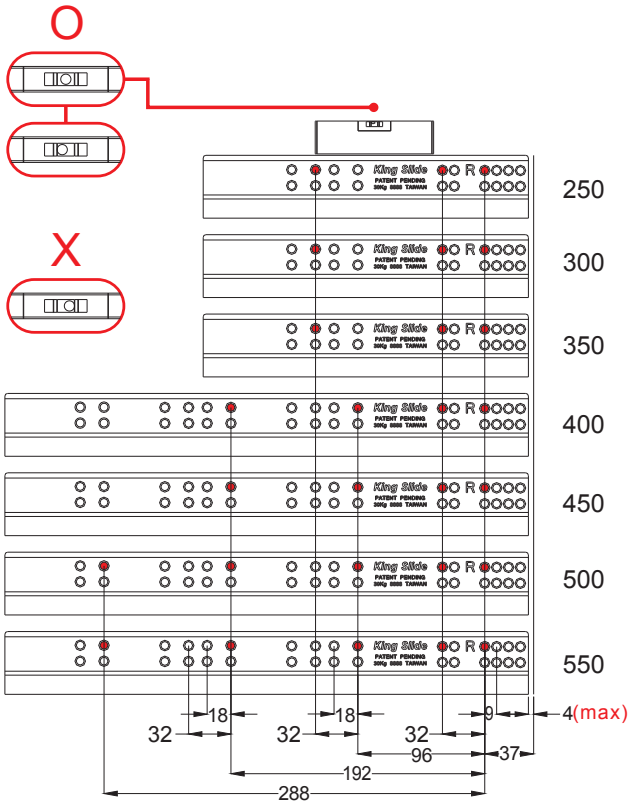

Note: Holes other than those shown may be in the slide member at King Slide's option and may change without notice.

Space Requirement

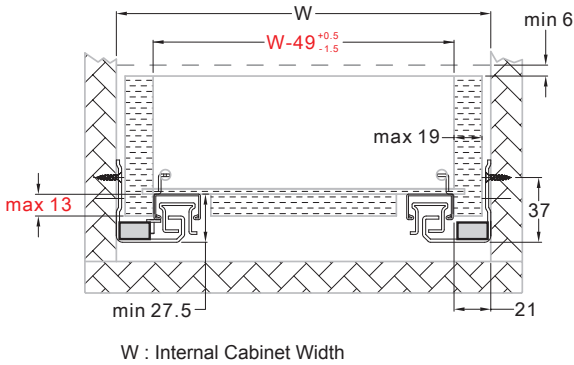

○	
Chipboard Screw	System Screw
X	
Round Head Screw	

Item No.	Total Length (mm)	Slide Travel (mm)	Max. Loading Capacity kg(lb) / pair
1B89-250	250	224	45 (100)
1B89-300	300	280	45 (100)
1B89-350	350	340	45 (100)
1B89-400	400	390	45 (100)
1B89-450	450	440	45 (100)
1B89-500	500	490	45 (100)
1B89-550	550	540	45 (100)

Easy Assembly with Front-End Installation

Tool-less Height Adjustment :
Simply rotate the wheel at the front bottom of the drawer to adjust the drawer height

Drawer Removal:
Simply press the front release device to remove the drawer

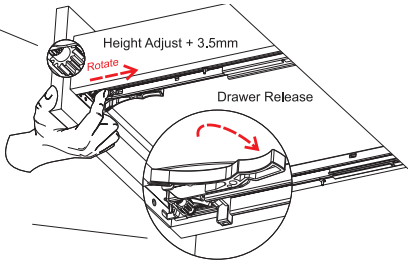

Our specially designed front-end installation allows quick and simple drawer installation and removal processes. The quick connect and disconnect device is located at the front-end under the drawer, keeping intact the elegant appearance of the drawer.

Installation Instruction

1A89 & 1B89

- 1. Before installing the slides, make sure the dimensions of the cabinet and drawer meet the requirements specified in Fig. 1 and 2.
- 2. Drill holes on the cabinet following the 'Cabinet Holes Position' drawing on the reverse page. Mount the slides on the cabinet using the recommended type of screws.
- 3. Make cut-outs on the drawer according to Fig. 3A and Fig. 3B's dimension (Using the drill template FL00ZD0-A as page 1.39 is recommended), then install the front release lever according to Fig. 3A.

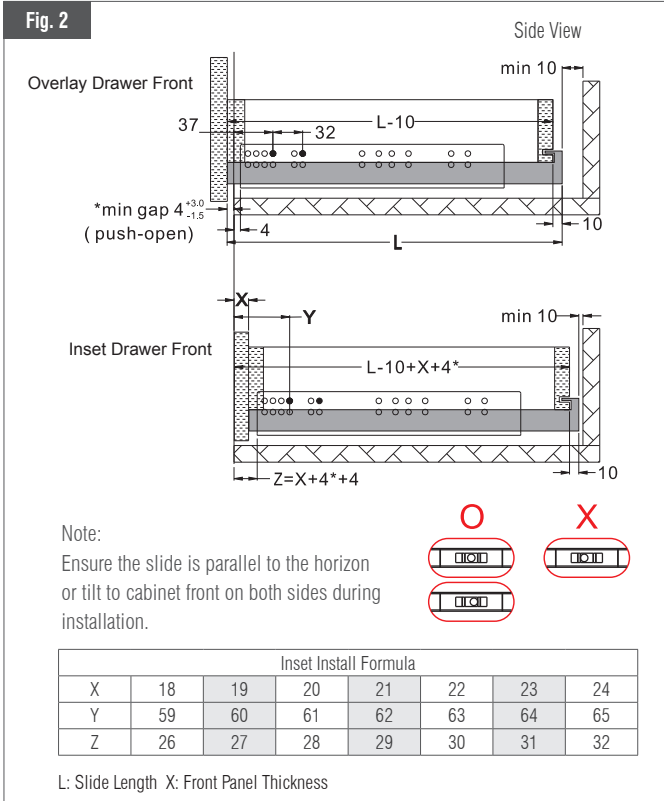
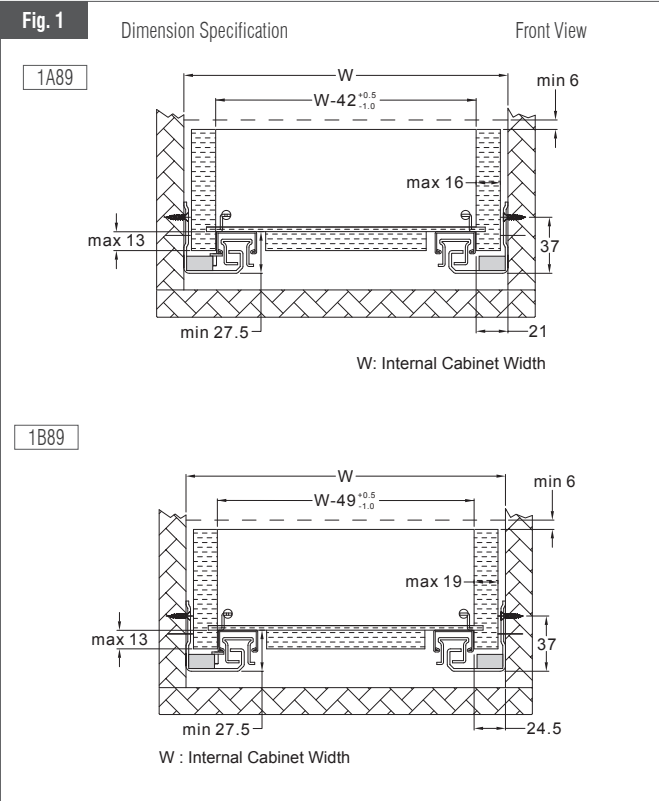

Installation Requirement

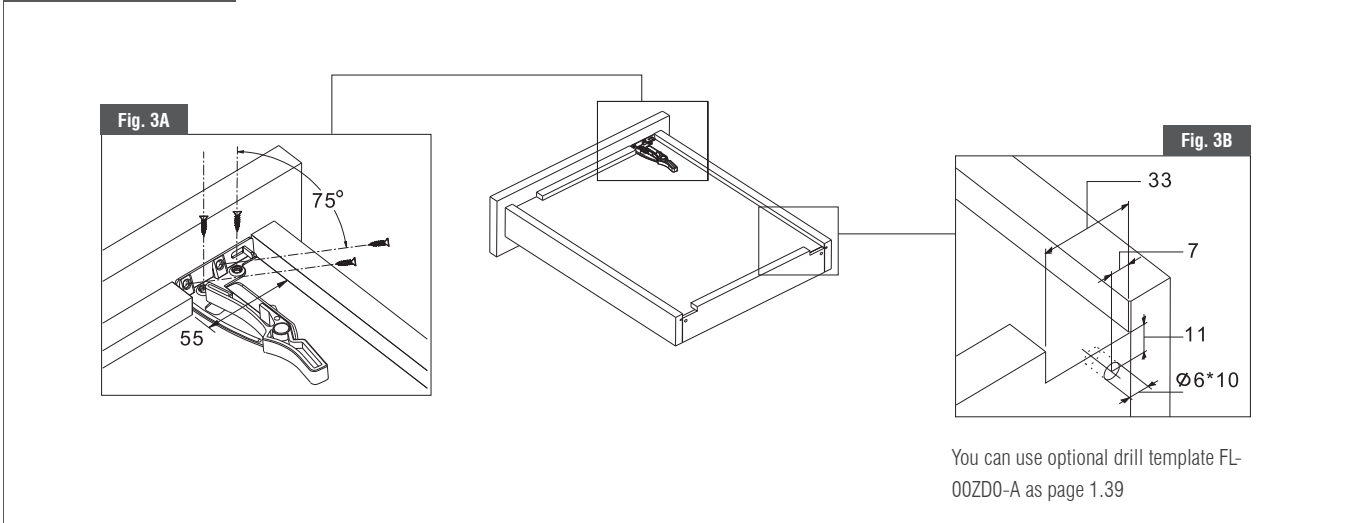

- 4. Pull out the slides on the cabinet.
- 5. Position and align the drawer with the slide as shown in Figs. 4A and 4B. Push the drawer all the way into the cabinet as shown in Fig. 4C until clicked to complete the installation.
- 6. After confirming the drawer is operating normally, install the front panel.
- 7. If height / depth adjustment is needed after installation, please refer to the Detail Adjustment Info. below or the feature diagram on the previous page.

Fig. 4A

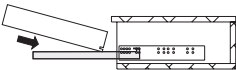

Fig. 4B

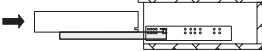
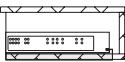
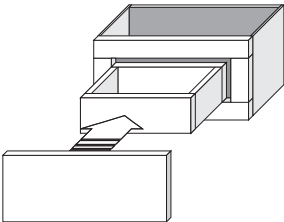

Fig. 4C



Notice

To prevent installation errors which may lead to the drawer getting stuck, Please make sure the normal operation of the drawer before securing the front panel.



Detail Adjustment Info

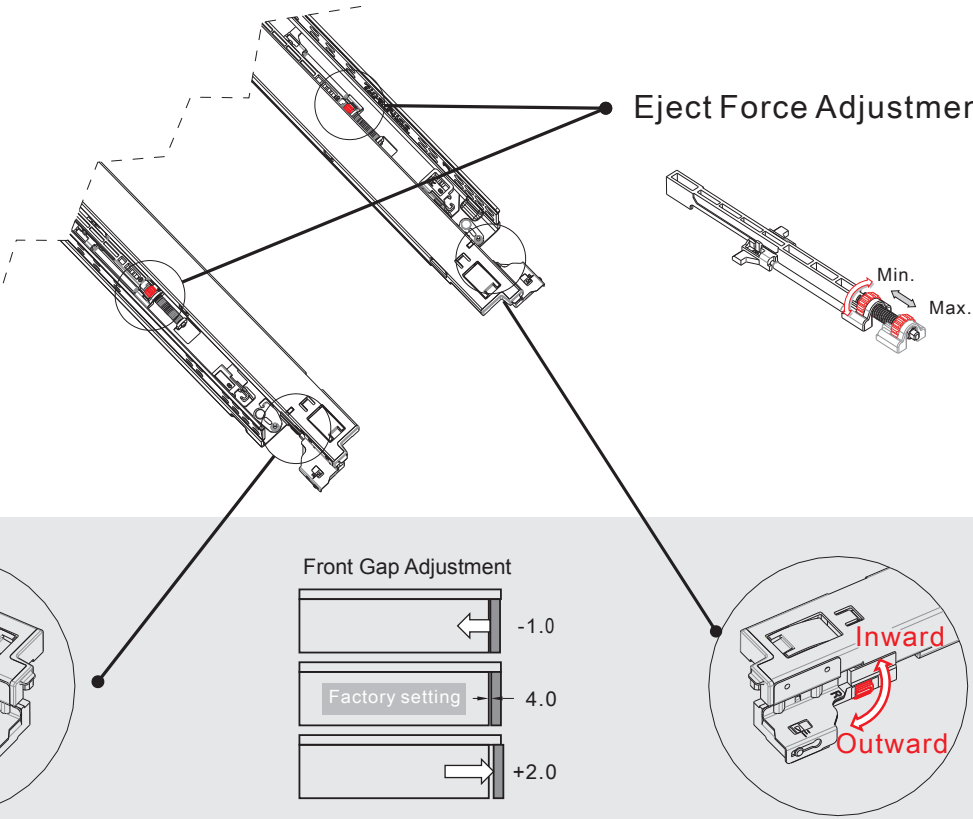

Eject Force Adjustment

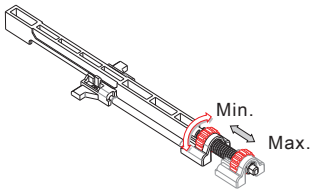

Front Gap Adjustment

Adjustment	Value
Outward	-1.0
Factory setting	4.0
Inward	+2.0

Inward/Outward Adjustments

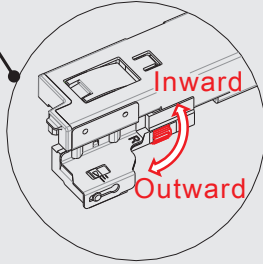
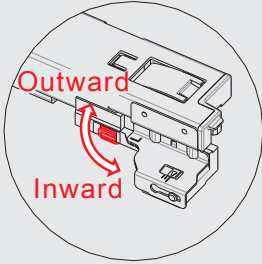

Notes for installation

- 1. Ensure the drawer body appearance is upright. It could not be diamond trapezoidal or distorted!
- 2. Ensure the side space, depth on both sides are consistent.
- 3. Ensure the installation location or the cabinet is on a flat surface.
- 4. Ensure the front release lever is installed correctly.
- 5. Ensure the drawer dimensions, rear notch locking hole, internal drawer width, and the drawer bottom recess are correct.

1A89F

Push-Open Undermount Slide
for Face Frame Cabinet (16mm)



Specifications

- **Length:** 229 / 305 / 381 / 457 / 533mm
9" / 12" / 15" / 18" / 21"
- **Travel:** Full Extension
- **Maximum Drawer Side Thickness:** 16mm
- **Max. Load Capacity:** 45 kg(100 lb)/pair
- **Mount:** Undermount
- **Material:** Galvanized Steel
- **Packing:** Unit Packed in 2 pairs/carton
6 pairs/carton

Features

- Handle-free push-open allowing for complete drawer access even when hands are full
- Drawers can be ejected to its full extent even when at its full weight bearing capacity
- All mechanical device, instead of electric-driven, ergonomic and energy saving
- Undermount with full extension travel length
- Ultra smooth with high rigidity and stability design
- Signature patent pending tool-less ejection-force adjustment to fit your convenience
- Ergonomic design to increase usability and efficiency
- 2 dimensional trimming system provides tool-less height and depth adjustments
- Effortless assembly and removal of drawer with front release lever
- High dynamic loading capacity of 34kg (75lb) with 100,000 life cycles, or 45kg (100lb) with 50,000 life cycles
- High installation allowances for drawer width: +0.5/-1.5 mm, and for drawer depth: +1/-1 mm

Applications

- For Face Frame Cabinet :
Kitchen Furniture, Kitchen Cabinetry, Home Cabinetry and Box Drawers

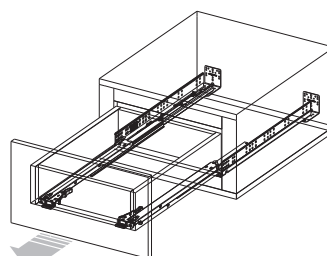

Space Requirement

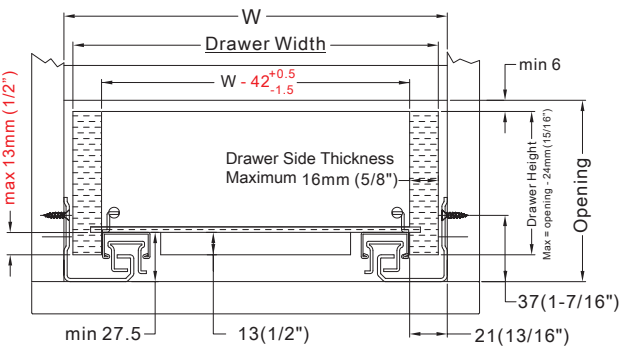

Drawer Width Formula	
Drawer Side Thickness mm (inch)	"W" minus mm (inch)
16 (5/8")	10 (3/8")
15 (19/32")	12 (15/32")
14 (9/16")	14 (9/16")
13 (1/2")	16 (5/8")
12 (15/32")	18 (23/32")

W: Internal Cabinet Width
Example:
Internal Cabinet Width = 457 mm (18")
Drawer Side Thickness = 13 mm (1/2")
Drawer width = 457 - 16 = 441^{+0.5}_{-1.5} mm
= (18") - (5/8") = 17-3/8"

Dimension Specifications

Note: Holes other than those shown may be in the slide member at King Slide's option and may change without notice.

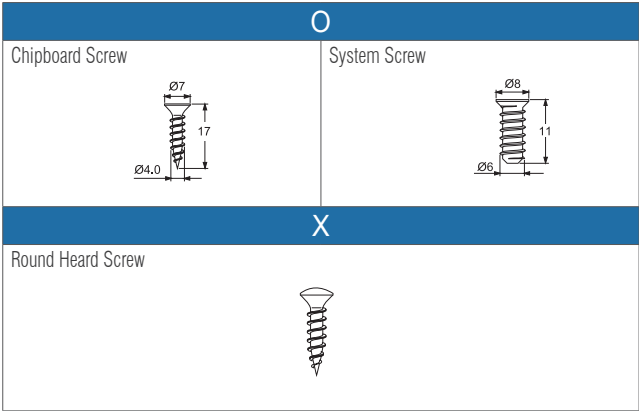
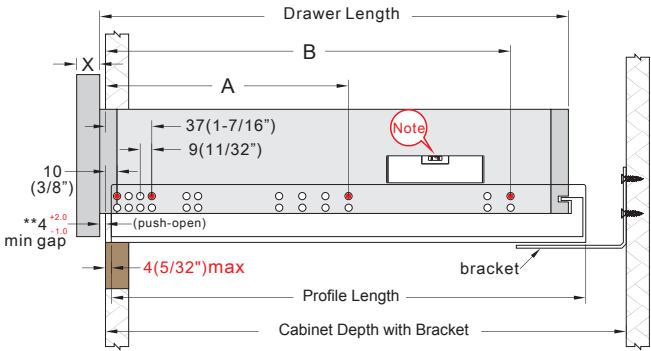

Note:
Ensure the slide is parallel to the horizon
or tilt to cabinet front on both sides during
installation.

Item No.	Drawer Length mm (inch)	Overall Cabinet Depth mm (inch)	Cabinet Depth With Bracket mm (inch)		Profile Length mm (inch)	System Screw Locations mm (inch)	
			MAX	MIN		A	B
1A89F229	229 (9")	305 (12")	299 (11-25/32")	266 (10-15/32")	256 (10-1/16")	133 (5-1/4")	229 (9")
1A89F305	305 (12")	381 (15")	369 (14-9/16")	326 (12-7/8")	317 (12-1/2")	165 (6-1/2")	261 (10-1/4")
1A89F381	381 (15")	457 (18")	446 (17-9/16")	403 (15-7/8")	394 (15-1/2")	165 (6-1/2")	357 (14-1/16")
1A89F457	457 (18")	533 (21")	522 (20-9/16")	479 (18-7/8")	470 (18-1/2")	261 (10-1/4")	453 (17-13/16")
1A89F533	533 (21")	610 (24")	598 (23-9/16")	555 (21-7/8")	546 (21-1/2")	261 (10-1/4")	517 (20-3/8")

Fit with American standard 3" cabinet depth system.

Easy Assembly with Front-End Installation

Tool-less Height Adjustment :
Simply rotate the wheel at the front bottom of the
drawer to adjust the drawer height

Drawer Removal:
Simply press the front release device to remove the
drawer

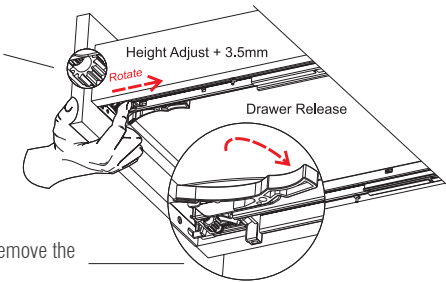

Our specially designed front-end installation allows
quick and simple drawer installation and removal
processes. The quick connect and disconnect device
is located at the front-end under the drawer, keeping
intact the elegant appearance of the drawer.

1B89F

Push-Open Undermount Slide
for Face Frame Cabinet (19mm)



Specifications

- **Length:** 229 / 305 / 381 / 457 / 533mm
9" / 12" / 15" / 18" / 21"
- **Travel:** Full Extension
- **Maximum Drawer Side Thickness:** 19mm
- **Max. Load Capacity:** 45 kg(100 lb)/pair
- **Mount:** Undermount
- **Material:** Galvanized Steel
- **Packing:** Unit Packed in 2 pairs/carton
6 pairs/carton

Features

- Handle-free push-open allowing for complete drawer access even when hands are full
- Drawers can be ejected to its full extent even when at its full weight bearing capacity
- All mechanical device, instead of electric-driven, ergonomic and energy saving
- Undermount with full extension travel length
- Ultra smooth with high rigidity and stability design
- Signature patent pending tool-less ejection-force adjustment to fit your convenience
- Ergonomic design to increase usability and efficiency
- 2 dimensional trimming system provides tool-less height and depth adjustments
- Effortless assembly and removal of drawer with front release lever
- High dynamic loading capacity of 34kg (75lb) with 100,000 life cycles, or 45kg (100lb) with 50,000 life cycles
- High installation allowances for drawer width: +0.5/-1.5 mm, and for drawer depth: +1/-1 mm

Applications

- For Face Frame Cabinet : Kitchen Furniture, Kitchen Cabinetry, Home Cabinetry and Box Drawers

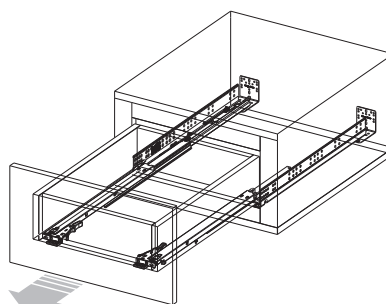

Space Requirement

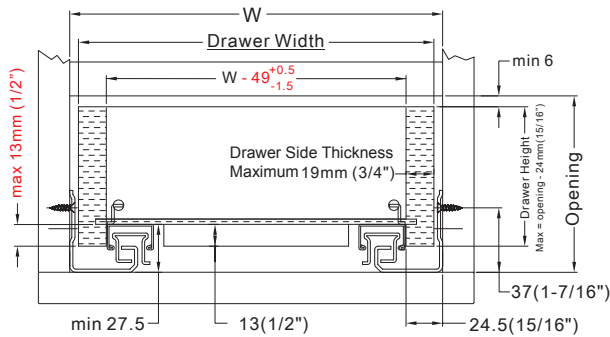

Drawer Width Formula	
Drawer Side Thickness mm (inch)	"W" minus mm (inch)
19 (3/4")	11 (7/16")
18 (23/32")	13 (1/2")
17 (21/31")	15 (19/32")
16 (5/8")	17 (21/32")
15 (19/32")	19 (3/4")

W: Internal Cabinet Width
Example:
Internal Cabinet Width = 457 mm (18")
Drawer Side Thickness = 19 mm (3/4")
Drawer width = 457 - 11 = 446 ^{+0.5}/_{-1.5} mm
= (18") - (7/16") = 17-9/16"

Dimension Specifications

Note: Holes other than those shown may be in the slide member at King Slide's option and may change without notice.

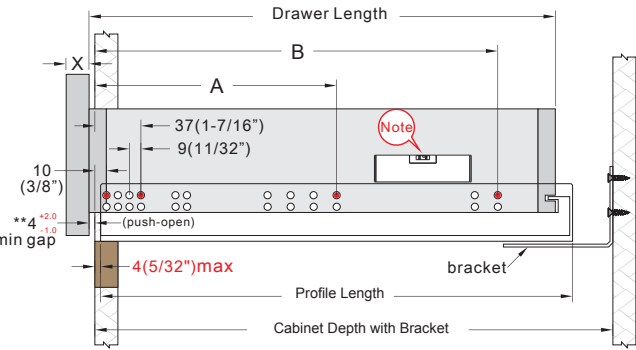

Note:
Ensure the slide is parallel to the horizon
or tilt to cabinet front on both sides during
installation.

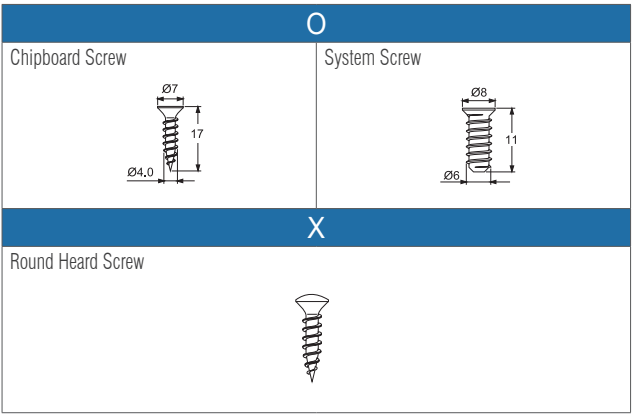
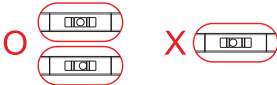

Item No.	Drawer Length mm (inch)	Overall Cabinet Depth mm (inch)	Cabinet Depth With Bracket mm (inch)		Profile Length	System Screw Locations mm (inch)	
			MAX	MIN		A	B
1B89F229	229 (9")	305 (12")	299 (11-25/32")	266 (10-15/32")	256 (10-1/16")	133 (5-1/4")	229 (9")
1B89F305	305 (12")	381 (15")	369 (14-9/16")	326 (12-7/8")	317 (12-1/2")	165 (6-1/2")	261 (10-1/4")
1B89F381	381 (15")	457 (18")	446 (17-9/16")	403 (15-7/8")	394 (15-1/2")	165 (6-1/2")	357 (14-1/16")
1B89F457	457 (18")	533 (21")	522 (20-9/16")	479 (18-7/8")	470 (18-1/2")	261 (10-1/4")	453 (17-13/16")
1B89F533	533 (21")	610 (24")	598 (23-9/16")	555 (21-7/8")	546 (21-1/2")	261 (10-1/4")	517 (20-3/8")

Fit with American standard 3" cabinet depth system.

Easy Assembly with Front-End Installation

Tool-less Height Adjustment :
Simply rotate the wheel at the front bottom of the
drawer to adjust the drawer height

Drawer Removal:
Simply press the front release device to
remove the drawer

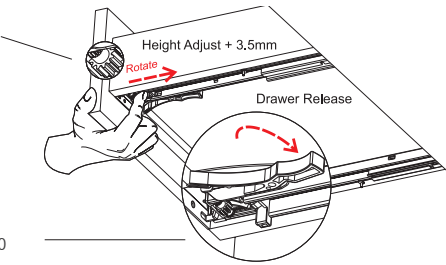

Our specially designed front-end installation allows quick and simple drawer installation and removal processes. The quick connect and disconnect device is located at the front-end under the drawer, keeping intact the elegant appearance of the drawer.

Installation Instruction

1A89F & 1B89F

- 1. Before installing the slides, make sure the dimensions of the cabinet and drawer meet the requirements specified in Fig. 1 and 'Space Requirement' drawing respectively for the slide to be installed.
- 2. Drill holes on the cabinet following the 'Installation Specification' drawing on the reverse page. Mount the slides and the rear brackets on the cabinet using the recommended type of screws.
- 3. Make cut-outs on the drawer according to Fig. 2A's dimension (Using the drill template FL00ZD0-A as page 1.39 is recommended), then install the front release lever according to Fig. 2B and 2C.
- 4. Pull out the slides on the cabinet.

Fig. 1

Dimension Specification

Front View

Normal Install

Inset Install

	X	16	17	18	19	20	21	22
Y	57	58	59	60	61	62	63	
Z	24	25	26	27	28	29	30	

L: Slide Length X: Front Panel Thickness

Note:

Ensure the slide is parallel to the horizon or tilt to cabinet front on both sides during installation.

O

X

Installation Requirement

Fig. 2B

Locking Device

75°

Fig. 2C

Extension Plastic

Locking Device and Extension Plastic

Fig. 2A

33(1- 5/16") Rear Notch

7(9/32")

11(7/16")

Ø6 * 10

You can use optional drill template FL-00ZD0-A as page 1.39

Rear Bracket

*Minimum 3 screws per bracket

1.26

King Slide reserves the right to alter specifications of all the products without notice. If the entity is different from the illustration, please refer to the entity.

- 5. Position and align the drawer with the slide as shown in Figs. 3A and 3B. Push the drawer all the way into the cabinet as shown in Fig. 3C until clicked to complete the installation.
- 6. After confirming the drawer is operating normally, install the front panel.
- 7. If height / depth adjustment is needed after installation, please refer to the Detail Adjustment Info. below or the feature diagram on the previous page.

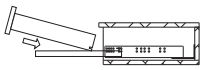
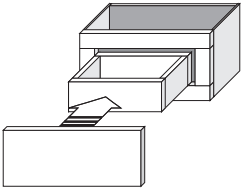
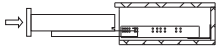
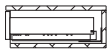
Fig. 3A		Notice To prevent installation errors which may lead to the drawer getting stuck, Please make sure the normal operation of the drawer before securing the front panel.	
Fig. 3B			
Fig. 3C			

Detail Adjustment Info

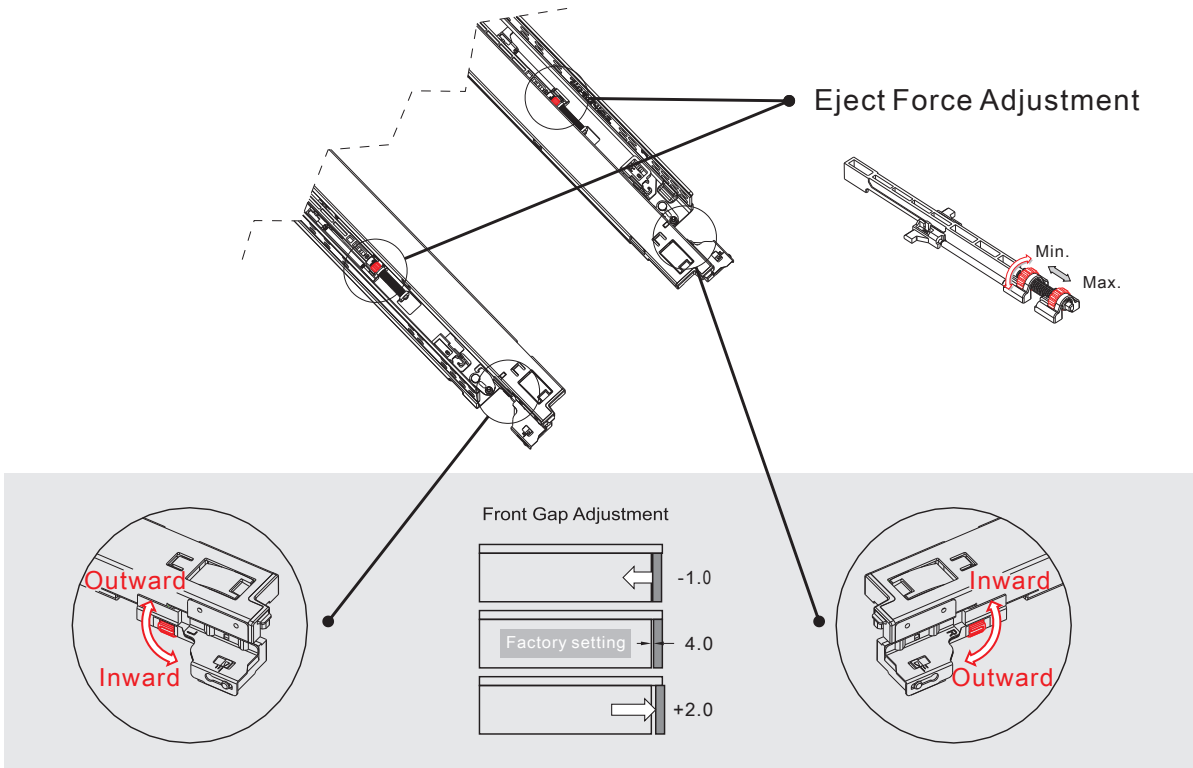

Eject Force Adjustment

Front Gap Adjustment

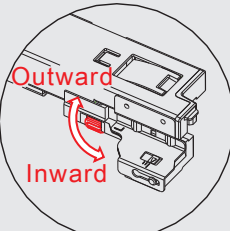
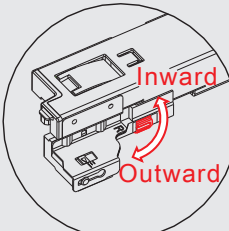
	-1.0
	4.0
	+2.0

Notes for installation

- 1. Ensure the drawer body appearance is upright. It could not be diamond trapezoidal or distorted!
- 2. Ensure the side space, depth and on both sides are consistent.
- 3. Ensure the installation location or the cabinet is on a flat surface.
- 4. Ensure the front release lever is installed correctly.
- 5. Ensure the drawer dimensions, rear notch locking hole, internal drawer width, and the drawer bottom recess are correct.

1A68

SIMPLEX—

Silent Soft-Closing Undermount Slide (16mm)



Specifications

- **Length:** 250mm to 600mm
- **Travel:** Full Extension
- **Maximum Drawer Side Thickness:** 16mm
- **Max. Load Capacity:** 45 kg(100 lb)/pair
- **Mount:** Undermount
- **Material:** Galvanized Steel
- **Packing:** Unit Packed in 2 pairs/carton
6 pairs/carton

Features

- Undermount with full extension travel length
- Ultra smooth gliding motion with high rigidity and stability design
- Enhanced silent soft-closing feature with light opening force
- Durable damping system with fast response capability
- Tool-less drawer height adjustment from the drawer front with 3.5 mm range
- Effortless assembly and removal of drawer with front release latch
- High dynamic loading capacity of 34kg (75lb) with 100,000 life cycles, or 45kg (100lb) with 50,000 life cycles

Applications

- For Frameless Cabinet : Kitchen Furniture, Kitchen Cabinetry, Home Cabinetry and Box Drawers

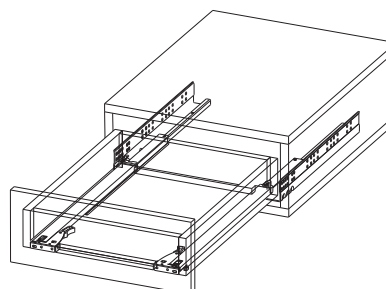

Dimension Specifications

Cabinet Holes Position

• Red Dots : Minimum Screw Required

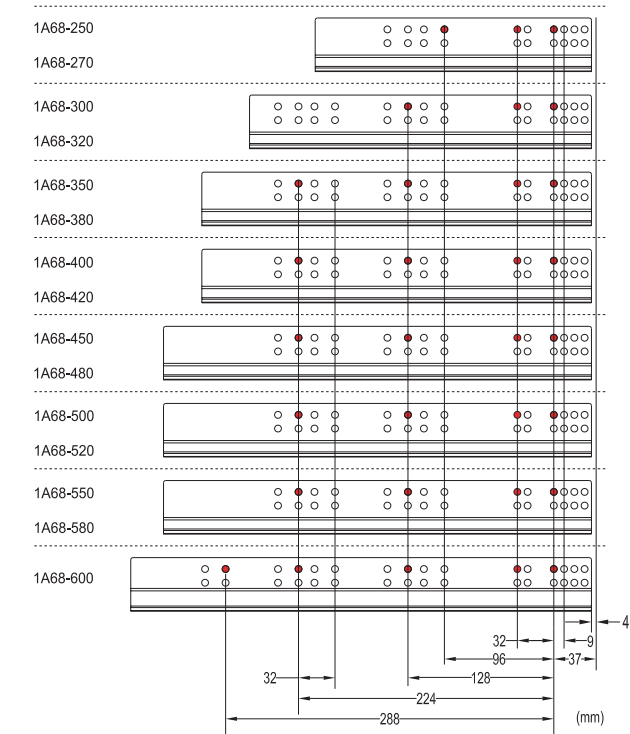

Note: Holes other than those shown may be in the slide member at King Slide's option and may change without notice.

Space Requirement

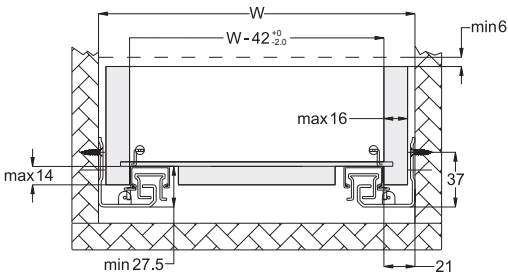

Overlay installation

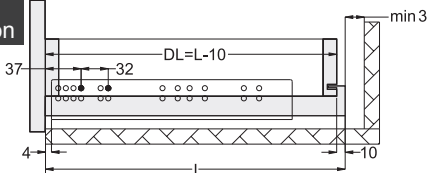

Inset installation

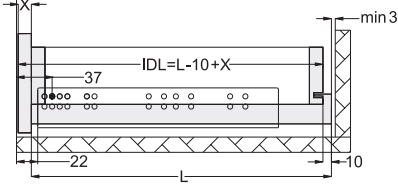

○		X
Chipboard Screws	System Screws	Round Head Screw

Item No.	Total Length (mm)	Slide Travel (mm)	Self-Closing Travel (mm)	Max. Loading Capacity kg(lb) / pair
1A68-250	250	224	25	45 (100)
1A68-270	270	244	25	45 (100)
1A68-300	300	280	38	45 (100)
1A68-320	320	300	38	45 (100)
1A68-350	350	340	50	45 (100)
1A68-380	380	370	50	45 (100)
1A68-400	400	390	50	45 (100)
1A68-420	420	410	50	45 (100)
1A68-450	450	440	50	45 (100)
1A68-480	480	470	50	45 (100)
1A68-500	500	490	50	45 (100)
1A68-520	520	510	50	45 (100)
1A68-550	550	540	50	45 (100)
1A68-580	580	570	50	45 (100)
1A68-600	600	590	50	45 (100)

Easy Assembly with Front-End Installation

Tool-less Height Adjustment :
Simply rotate the wheel at the front bottom of the drawer to adjust the drawer height

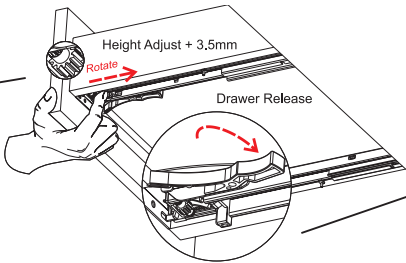

1B68

SIMPLEX—

Silent Soft-Closing Undermount Slide (19mm)



Specifications

- **Length:** 250mm to 600mm
- **Travel:** Full Extension
- **Maximum Drawer Side Thickness:** 19mm
- **Max. Load Capacity:** 45 kg(100 lb)/pair
- **Mount:** Undermount
- **Material:** Galvanized Steel
- **Packing:** Unit Packed in 2 pairs/carton
6 pairs/carton

Features

- Undermount with full extension travel length
- Ultra smooth gliding motion with high rigidity and stability design
- Enhanced silent soft-closing feature with light opening force
- Durable damping system with fast response capability
- Tool-less drawer height adjustment from the drawer front with 3.5 mm range
- Effortless assembly and removal of drawer with front release lever
- High dynamic loading capacity of 34kg (75lb) with 100,000 life cycles, or 45kg (100lb) with 50,000 life cycles

Applications

- For Frameless Cabinet :
Kitchen Furniture, Kitchen Cabinetry, Home Cabinetry and Box Drawers

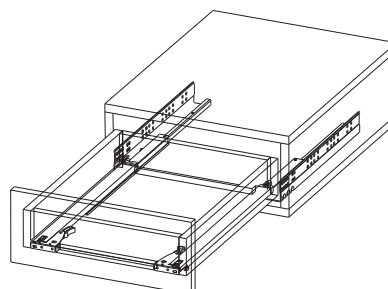

Dimension Specifications

Cabinet Holes Position

• Red Dots : Minimum Screw Required

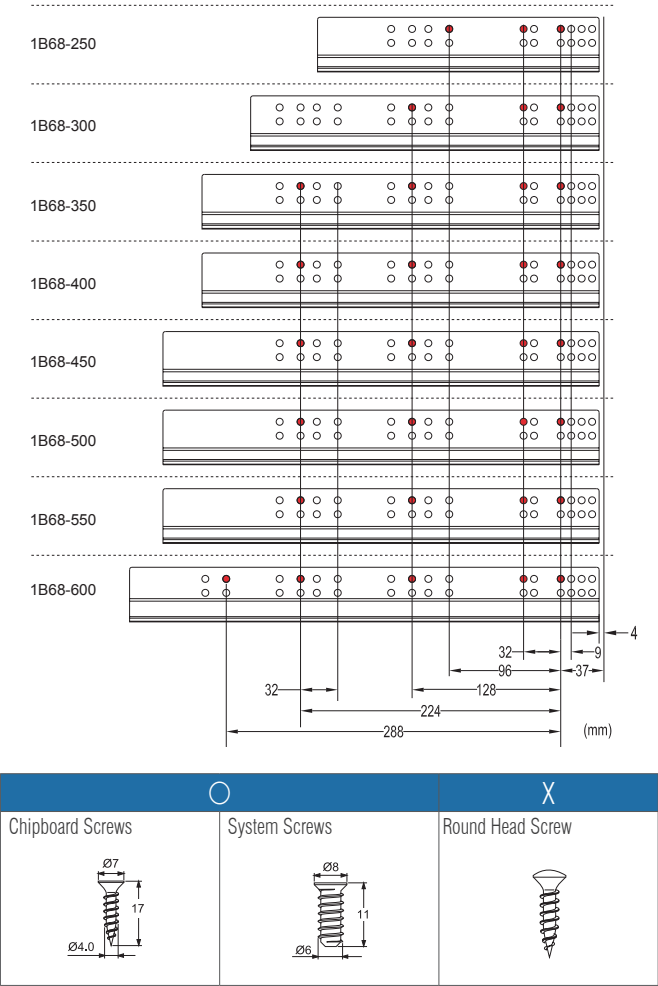

Space Requirement

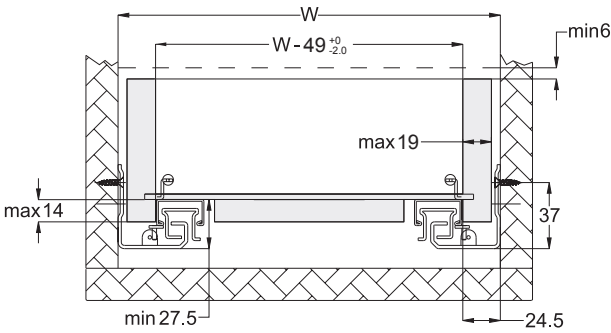

Overlay installation

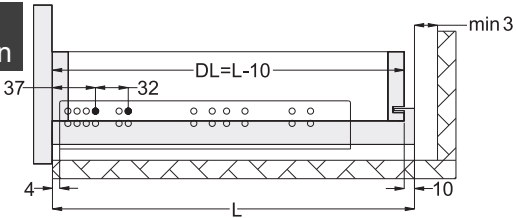

Inset installation

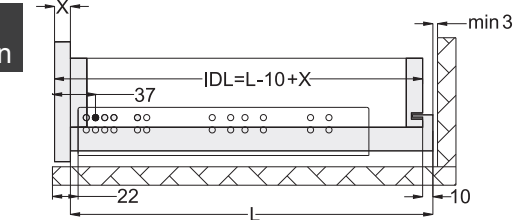

Note: Holes other than those shown may be in the slide member at King Slide's option and may change without notice.

Item No.	Total Length (mm)	Slide Travel (mm)	Self-Closing Travel (mm)	Max. Loading Capacity kg(lb) / pair
1B68-250	250	224	25	45 (100)
1B68-300	300	280	38	45 (100)
1B68-350	350	340	50	45 (100)
1B68-400	400	390	50	45 (100)
1B68-450	450	440	50	45 (100)
1B68-500	500	490	50	45 (100)
1B68-550	550	540	50	45 (100)
1B68-600	600	590	50	45 (100)

Easy Assembly with Front-End Installation

Tool-less Height Adjustment :
Simply rotate the wheel at the front bottom of the drawer to adjust the drawer height

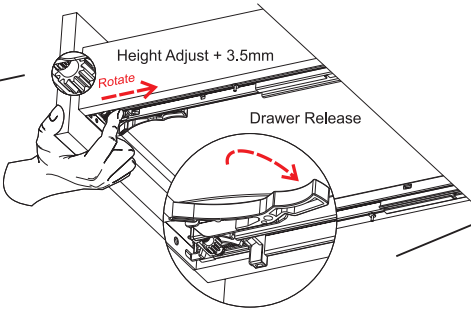

Drawer Removal:
Simply press the front release device to remove the drawer

Installation Instruction

1A68 & 1B68

- 1. Before installing the slides, make sure the dimensions of the cabinet and drawer meet the requirements specified in Fig. 1 and 2.
- 2. Drill holes on the cabinet following the 'Cabinet Holes Position' drawing on the reverse side. Install the slides on the cabinet using the recommended type of screws.
- 3. Make cut-outs on the bottom of drawer as indicated in Fig. 3A and 3B and attach the front release lever to the drawer as shown in Fig. 3C.
- 4. Pull out the slides on the cabinet.

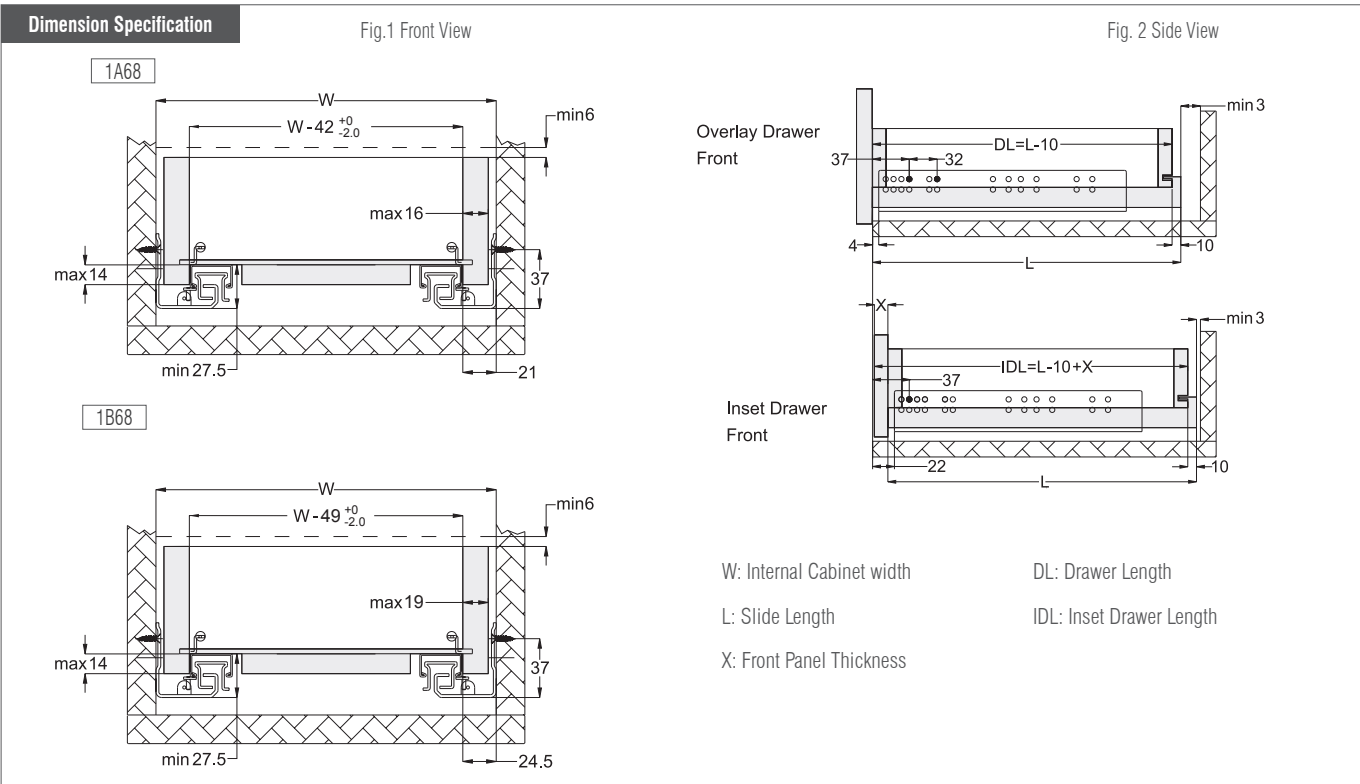

Easy Assembly with Front-End Installation

Our specially designed front end installation allows quick and simple drawer installation and removal processes. The quick connect and disconnect device is located at the front end under the drawer, keeping intact the elegant appearance of the drawer.



Tool-less Height Adjustment :
Simply rotate the wheel at the front bottom of the drawer to adjust the drawer height

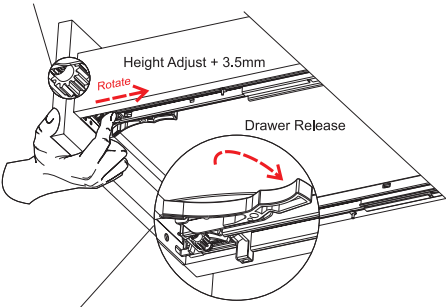

Drawer Removal:
Simply press the front release device to remove the drawer

5. Position the drawer on the slide as shown in Fig. 4A, Push and lower the drawer all the way into the cabinet and down to the slide until clicked to complete the installation as in Fig. 4B and 4C.

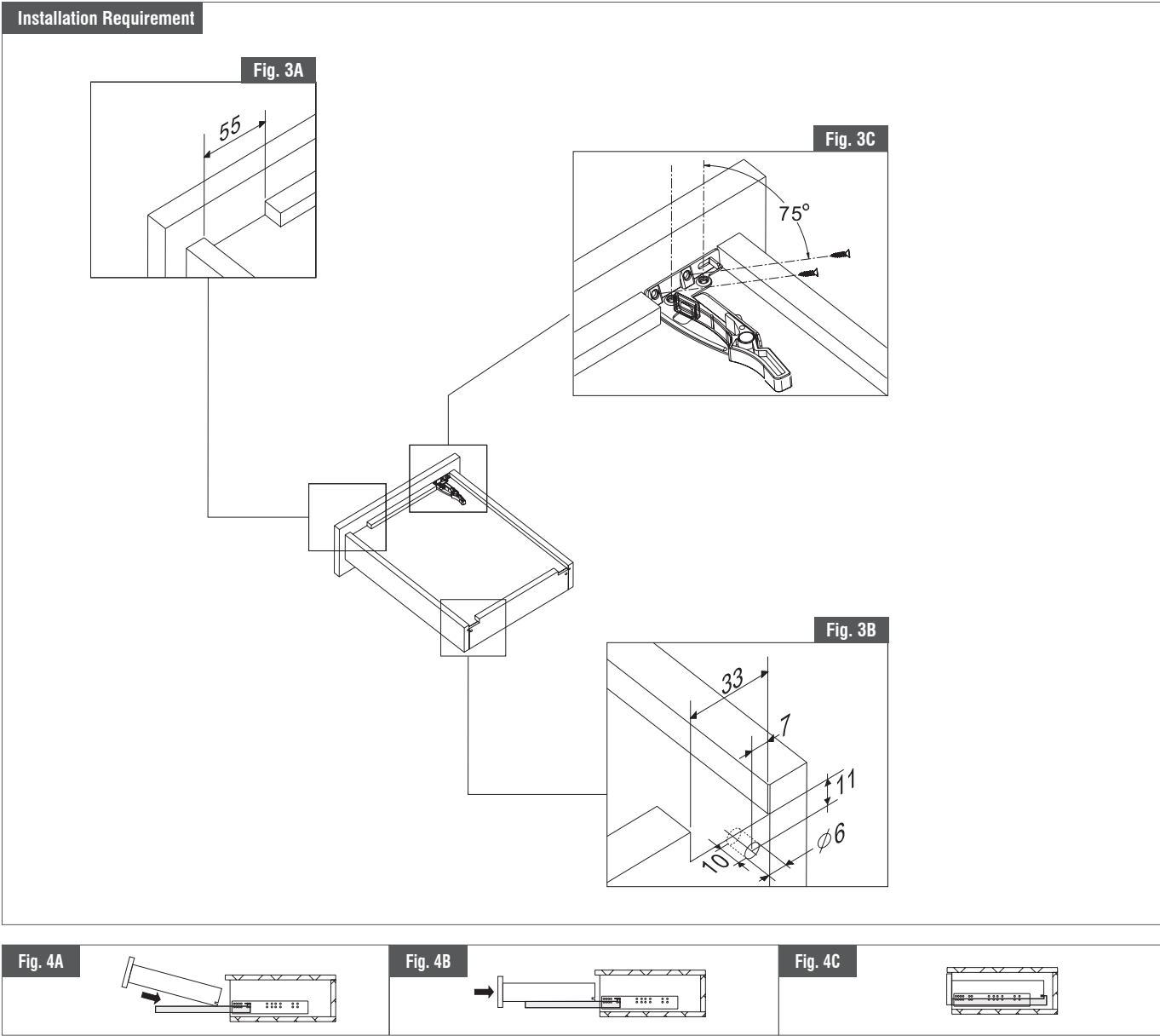

1A68F

SIMPLEX—

Silent Soft-Closing Undermount Slide
for Face Frame Cabinet (16mm)



Specifications

- **Length:** 229mm to 533mm
- **Travel:** Full Extension
- **Maximum Drawer Side Thickness:** 16mm
- **Max. Load Capacity:** 45 kg(100 lb)/pair
- **Mount:** Undermount
- **Material:** Galvanized Steel
- **Packing:** Unit Packed in 2 pairs/carton
6 pairs/carton

Features

- Undermount with full extension travel length
- Ultra smooth gliding motion with high rigidity and stability design
- Enhanced silent soft-closing feature with light opening force.
- Durable damping system with fast response capability
- Tool-less height adjustment from the drawer front with 3.5 mm range
- Effortless assembly and removal of drawer with front release lever
- High dynamic loading capacity of 34kg (75lb) with 100,000 life cycles, or 45kg (100lb) with 50,000 life cycles

Applications

- For Face Frame Cabinet : Kitchen Furniture, Kitchen Cabinetry, Home Cabinetry and Box Drawers

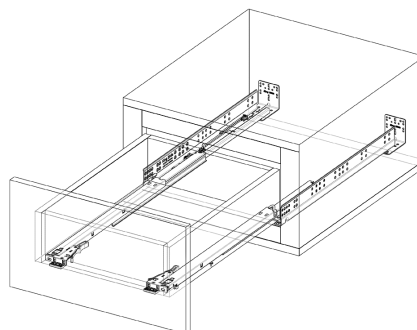

Dimension Specifications

Cabinet Holes Position

- Red Dots : Minimum Screw Required

Note: Ensure the slide is parallel to the horizon or tilt to cabinet front on both sides during installation.

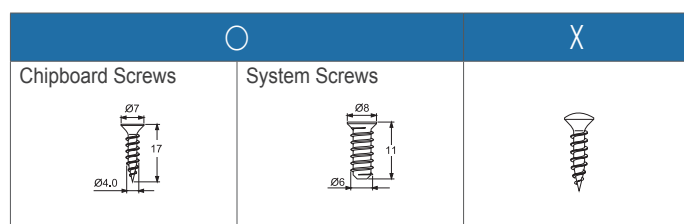
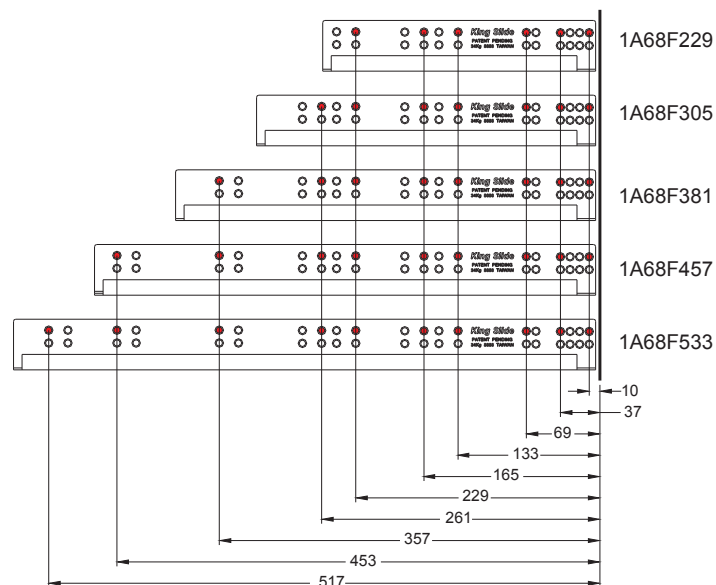

Space Requirement

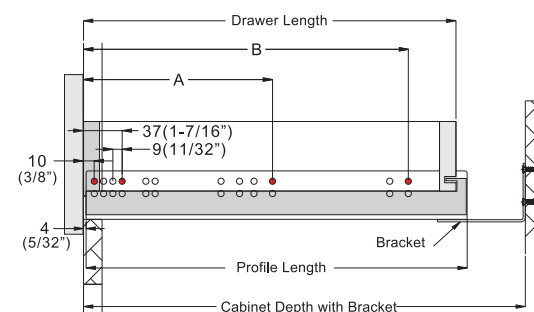
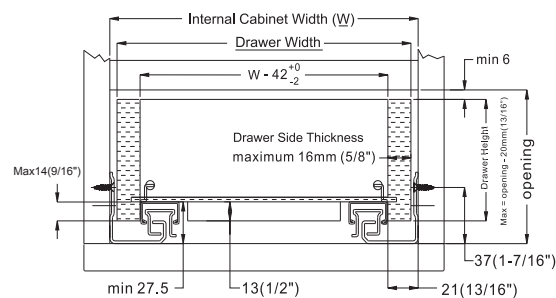

Drawer Width Formula	
Drawer Side Thickness mm (inch)	"W" minus mm (inch)
16 (5/8")	10 (3/8")
15 (19/32")	12 (15/32")
14 (9/16")	14 (9/16")
13 (1/2")	16 (5/8")
12 (15/32")	18 (23/32")

W: Internal Cabinet Width

Example:

Internal Cabinet Width = 457 mm (18")

Drawer Side Thickness = 13 mm (1/2")

$$\begin{aligned}\text{Drawer Width} &= 457 - 16 = 441^{+0}_{-2} \text{ mm} \\ &= (18") - (5/8") = 17-3/8"\end{aligned}$$

Note: Holes other than those shown may be in the slide member at King Slide's option and may change without notice.

Item No.	Drawer Length mm (inch)	Overall Cabinet Depth mm (inch)	Cabinet Depth With Bracket mm (inch)		Profile Length mm (inch)	System Screw Locations mm (inch)	
			MAX	MIN		A	B
1A68F229	229 (9")	305 (12")	299 (11-25/32")	266 (10-15/32")	256 (10-1/16")	133 (5-1/4")	229 (9")
1A68F305	305 (12")	381 (15")	369 (14-9/16")	326 (12-7/8")	317 (12-1/2")	165 (6-1/2")	261 (10-1/4")
1A68F381	381 (15")	457 (18")	446 (17-9/16")	403 (15-7/8")	394 (15-1/2")	165 (6-1/2")	357 (14-1/16")
1A68F457	457 (18")	533 (21")	522 (20-9/16")	479 (18-7/8")	470 (18-1/2")	261 (10-1/4")	453 (17-13/16")
1A68F533	533 (21")	610 (24")	598 (23-9/16")	555 (21-7/8")	546 (21-1/2")	261 (10-1/4")	517 (20-3/8")

Fit with American standard 3" cabinet depth system.

Easy Assembly with Front-End Installation

Tool-less Height Adjustment :
Simply rotate the wheel at the front bottom of the drawer to adjust the drawer height

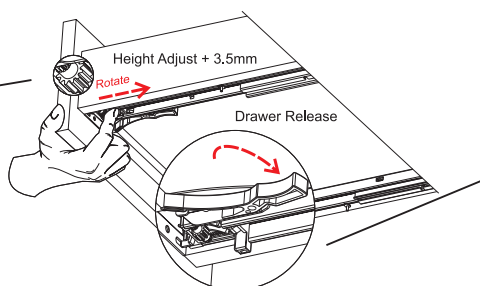

Drawer Removal:
Simply press the front release device to
remove the drawer

1B68F

SIMPLEX—

Silent Soft-Closing Undermount Slide
for Face Frame Cabinet (19mm)



Specifications

- **Length:** 229mm to 533mm
- **Travel:** Full Extension
- **Maximum Drawer Side Thickness:** 19mm
- **Max. Load Capacity:** 45 kg(100 lb)/pair
- **Mount:** Undermount
- **Material:** Galvanized Steel
- **Packing:** Unit Packed in 6 pairs/carton

Features

- Undermount with full extension travel length
- Ultra smooth gliding motion with high rigidity and stability design
- Enhanced silent soft-closing feature with light opening force.
- Durable damping system with fast response capability
- Tool-less height adjustment from the drawer front with 3.5 mm range
- Effortless assembly and removal of drawer with front release lever
- High dynamic loading capacity of 34kg (75lb) with 100,000 life cycles, or 45kg (100lb) with 50,000 life cycles

Applications

- For Face Frame Cabinet :
Kitchen Furniture, Kitchen Cabinetry,
Home Cabinetry and Box Drawers

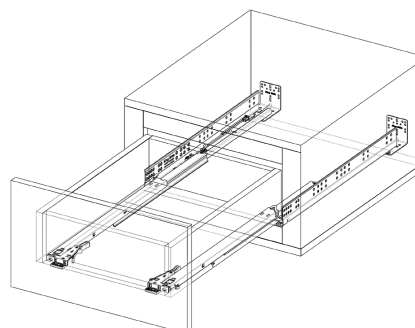

Space Requirement

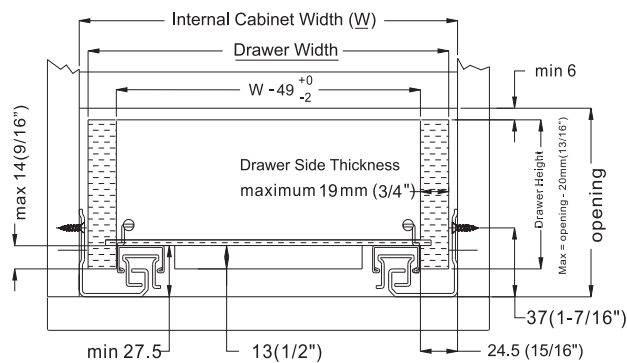

Drawer Width Formula	
Drawer Side Thickness mm (inch)	"W" minus mm (inch)
19 (3/4")	11 (7/16")
18 (23/32")	13 (1/2")
17 (21/31")	15 (19/32")
16 (5/8")	17 (21/32")
15 (19/32")	19 (3/4")

W: Internal Cabinet Width

Example:

Internal Cabinet Width = 457 mm (18")

Drawer Side Thickness = 19 mm (3/4")

Drawer Width = 457 - 11 = 446 ⁺⁰_{-2.0} mm
= (18") - (7/16") = 17-9/16"

Dimension Specifications

Note: Holes other than those shown may be in the slide member at King Slide's option and may change without notice.

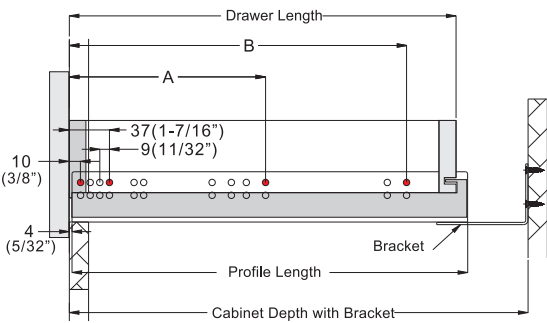

○		X
Chipboard Screws	System Screws	

Item No.	Drawer Length mm (inch)	Overall Cabinet Depth mm (inch)	Cabinet Depth With Bracket mm (inch)		Profile Length mm (inch)	System Screw Locations mm (inch)	
			MAX	MINmm (inch)		A	B
1B68F229	229 (9")	305 (12")	299 (11-25/32")	266 (10-15/32")	256 (10-1/16")	133 (5-1/4")	229 (9")
1B68F305	305 (12")	381 (15")	369 (14-9/16")	326 (12-7/8")	317 (12-1/2")	165 (6-1/2")	261 (10-1/4")
1B68F381	381 (15")	457 (18")	446 (17-9/16")	403 (15-7/8")	394 (15-1/2")	165 (6-1/2")	357 (14-1/16")
1B68F457	457 (18")	533 (21")	522 (20-9/16")	479 (18-7/8")	470 (18-1/2")	261 (10-1/4")	453 (17-13/16")
1B68F533	533 (21")	610 (24")	598 (23-9/16")	555 (21-7/8")	546 (21-1/2")	261 (10-1/4")	517 (20-3/8")

Fit with American standard 3" cabinet depth system.

Installation Instruction

1A68F & 1B68F

- 1.Before installing the slides, make sure the dimensions of the cabinet and drawer meet the requirements specified in 'Space Requirement' drawing respectively for the slide to be installed.
- 2.Drill holes on the cabinet following the 'Dimension Specifications' drawing on the reverse page. Mount the slides and the rear vrrackets on the cabinet using the recommended type of screws.
- 3.Make cut-outs on the drawer according to Fig. 1A's dimension (Using the drill template FL00ZD0-A as page 1.39 is recommended), then install the front release lever according to Figs. 1B and 1C.
- 4.Pull out the slides on the cabinet.
- 5.Position and align the drawer with the slide as shown in Figs. 2A and 2B. Push the drawer all the way into the cabinet as shown in Fig. 2C until clicked to complete the installation.

Installation Requirement

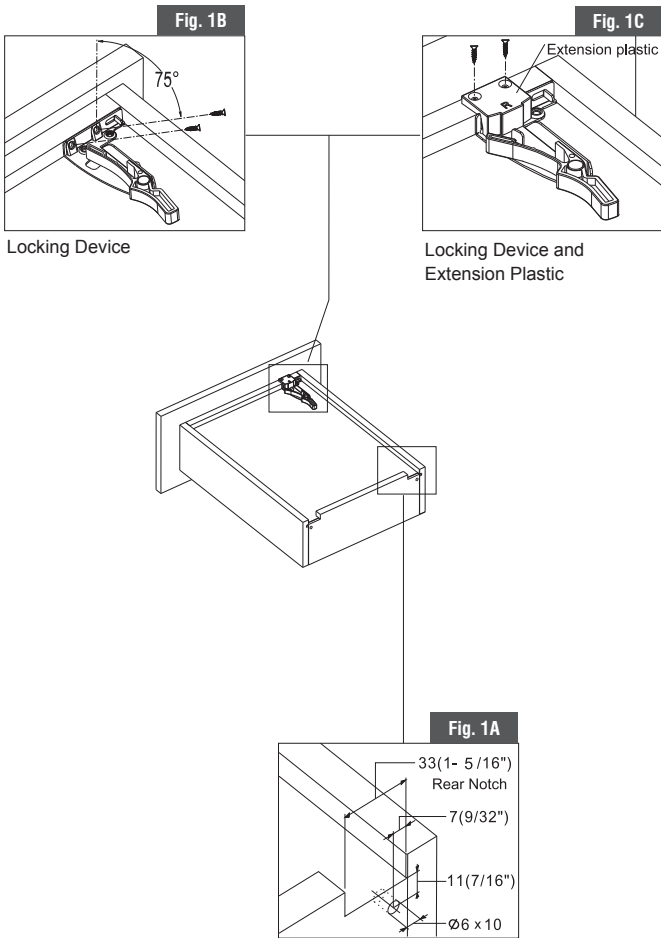

Fig. 2A

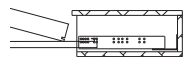

Fig. 2B

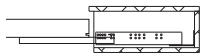
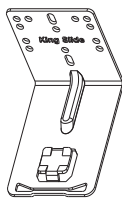

Fig. 2C



Rear Bracket



*Minimum 3 screws per bracket.

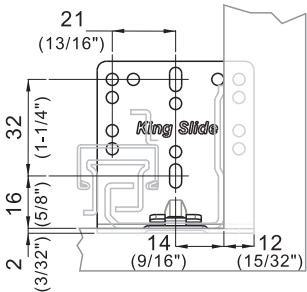

Easy Assembly with Front-End Installation

Our specially designed front end installation allows quick and simple drawer installation and removal processes. The quick connect and disconnect device is located at the front end under the drawer, keeping intact the elegant appearance of the drawer.



Tool-less Height Adjustment :
Simply rotate the wheel at the front bottom of the drawer to adjust the drawer height

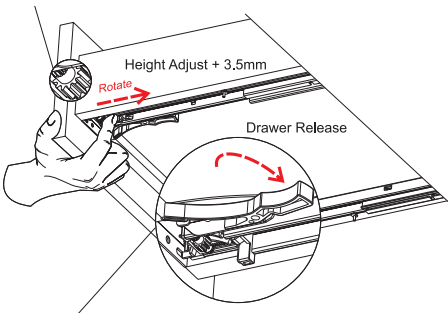

Drawer Removal:
Simply press the front release device to remove the drawer

Drill Template

Optional
Assembly Aid
FL00ZD0-A

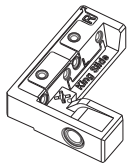

Holes for Locking Device
A: 2.5mm
a: 2.5mm

Holes for rear hook
B: 6mm (depth 10mm)

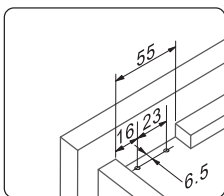
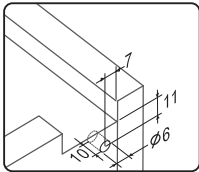

2.5mm
drill bit

2.5mm
drill bit

6.0mm
drill bit

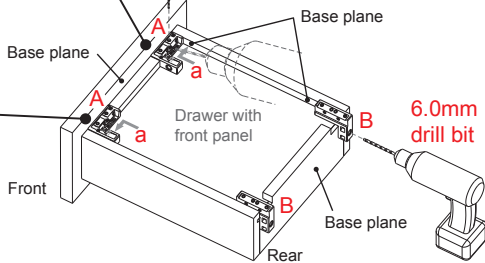
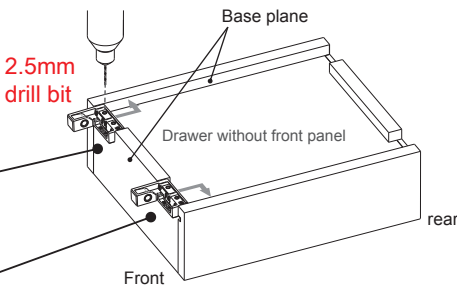
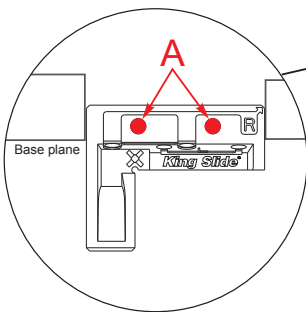

Accessories

Drill Template

Item No. FL00ZD0-A

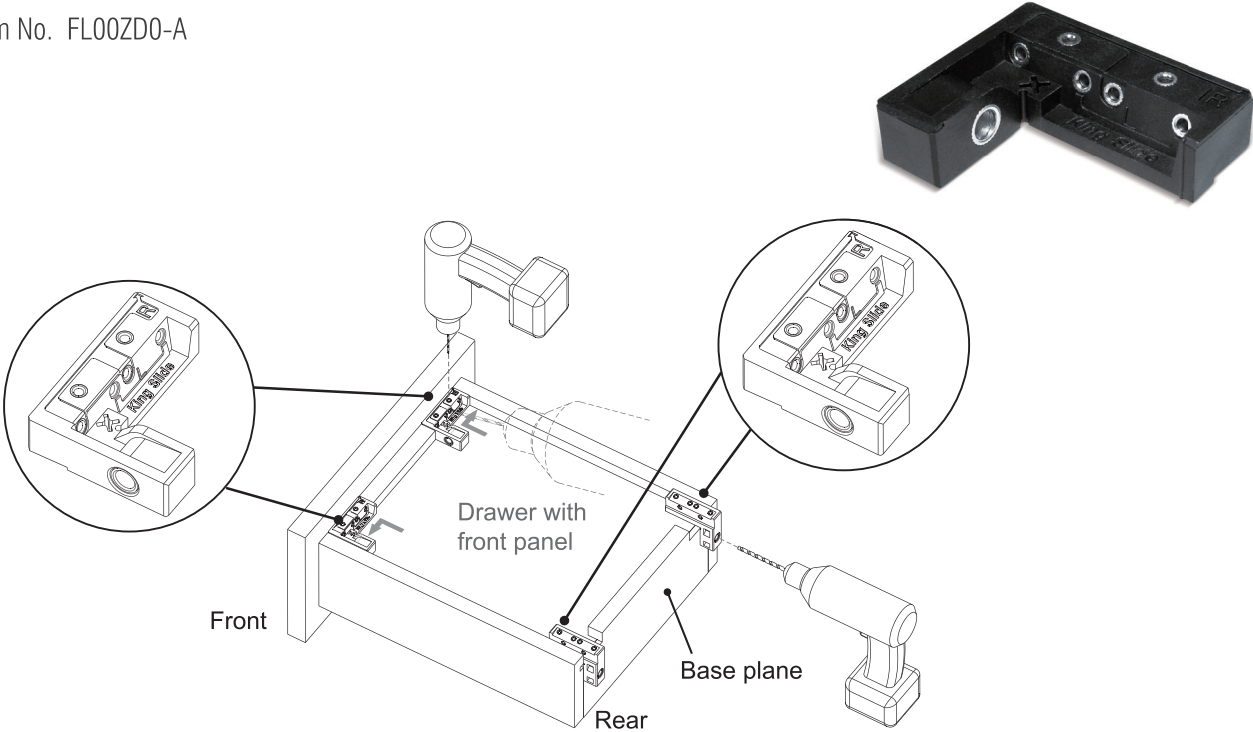

Depth Adjustable Accessories for Inset Drawer

Item No. : FL00ZG0-A

